



PRICE LIST 2024



VARIO PERFECT



SPECIFICATIONS - TECHNICS - OPTIONS - PRICES

VARIO STAR

COMFORT MOBILE 8 - 9 m.
Integrated motorhomes for two to four individuals. Only 2.33 meters wide. On chassis up to 8.8 t. Compact and highly manoeuvrable for a plus in driving comfort. Single or double beds. Roof increase in the tail for plenty of headroom in the sleeping area.

THE 2-PERSON MOTORHOME

VARIO Star	page	04
Powerfull chassis	page	04 - 05
Technical Data	page	06
Prices	page	07
Floor plans	page	08 - 09
Equipment components	page	10 - 19

VARIO PERFECT

LUXURY MOBILE 8 - 12 m.
VARIO Perfect. VARIO Perfect Platinum.
Integrated motorhomes on truck and bus chassis from 7.5 to 26 t.
Powerful chassis of Mercedes-Benz and MAN, individual floor plans with up to four slide outs and car garage as well as exceptional luxury are characteristic.

THE SPORTY LUXURY CLASS

VARIO Perfect	page	20 - 21
Powerfull chassis	page	22 - 23
Technical Data	page	24
Prices	page	25
Floor plans	page	26 - 29
Equipment components	page	30 - 47

VARIO ALKOVEN

FAMILY MOBILE 8 - 12 m.
Mobile home, which can accommodate two separate sleeping areas with at least four fixed beds. Chassis 7,5 to 26 t.
Different concepts for living areas guarantee maximum comfort. The original-cab of the chassis is maintained.

THE EXCLUSIVE ALCOVE

VARIO Alkoven	page	48 - 49
Powerfull chassis	page	50 - 51
Technical Data	page	52
Prices	page	53
Floor plans	page	54 - 55
Equipment components	page	56 - 69

VARIO SIGNATURE

EXCLUSIVE VEHICLE 10,5/12 m. 18/26 t.
The semi-integrated integrated one. Exclusive VARIO body construction and characterful front / platform of the XXL driver's cabin with variable seating order for fourfold pilot and co-pilot feeling. Living room with pull-down bed at full headroom, intelligent 360 ° all-round view system.

THE PROMINENT

VARIO Signature	page	70 - 71
Powerfull chassis	page	72 - 73
Technical Data	page	72 - 73
Prices	page	72 - 73
Floor plans	page	72 - 73
Equipment components	page	74 - 83

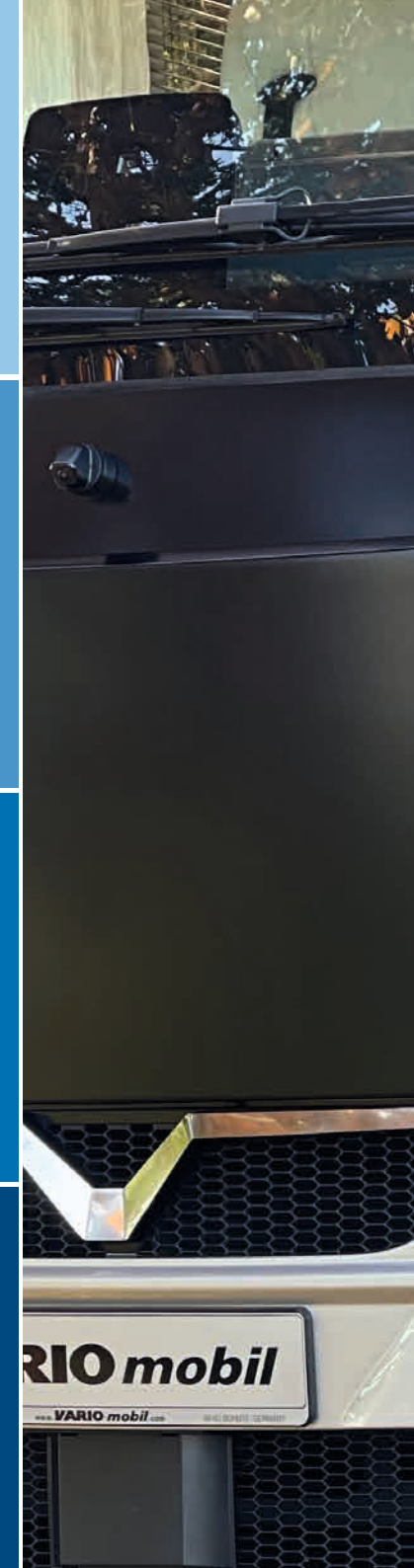



We build emotions.
Comfort packs for maximum safety.
Exclusive for discerning motorhome enthusiasts.

VARIO mobil

welcomes you.

In the belief that we coach-motorists discover new worlds with curiosity, courage and tolerance, each VARIOmobil is an exclusive unique with all modern conveniences. Custom built for you - for the best days of the year.

Your safety is our motive. With the introduction of the VARIO Perfect 1200 Platinum, the new model year begins. In the fine-tuning 2024, we have explored the entire range of technically possible options for you and built the very first motorhome with 4 slide outs.

A multitude of innovative safety and assistance systems are just as natural as the luxurious heating system and the rear garage in all 12-metre models.

Enjoy 100% PLANNING FREEDOM of floor plan, design and all equipment details. We are happy to realize your wishes with great attention to each detail and with more than 40 years experience in the automotive industry.

You are completely at home even when you are travelling in your exclusive motorhome

VARIO mobil



VARIO mobil

VARIO
PERFECT
PLUS

VARIO mobil



VARIO PERFECT

UNIQUE.
100 % CUSTOM MADE.

The VARIO Perfect

Exceptional luxury in the living area, pioneering technologies and maximum equipment variety characterize the VARIO Perfect.

It is based on the innovative chassis Mercedes - Benz Atego / Mercedes - Benz Actros, MAN TGL / TGM and MAN TGS.

The well engineered VARIO-double floor system is standard. Because of the raised drivers platform no motor cover disturbs between drivers and co-drivers seat. The total height of this vehicle type is at least 3,55 m.

The total length is 8 to 12 metres and the exterior width is 2.53 to 2.55 metres.

VARIO Perfect 1200

on the powerful front-engine chassis of MB Actros and MAN TGS, this body shape is suitable for 26-ton chassis with 3 axles.

This sporty luxury class provides the technical prerequisites for an exceptionally spacious rear garage, which as an option can accommodate your accompanying vehicle and even two e-bikes with a charging station on an extendable bike slide. No need to rearrange! Simply more mobility.

Great attention to detail and tailored individually for you. As a result, every VARIO mobil is a custom-made exclusive piece.

Chassis	MAN TGL 8.220 BL / 10.220 BL	MAN TGL 8.250 BL / 10.250 BL	MAN TGM 15.290 LL (TGM 13.290 BL 4x4)
Wheelbase	3.900 / 4.200 / 4.500 mm	3.900 / 4.200 / 4.500 mm	4.425 / 4.725 / 5.075 / 5.425 mm (4.250 mm)
GVWR	8.800 (7.490) kg / 10.000 kg	8.800 (7.490) kg / 10.000 kg	15.000 kg (14.100 kg)
Front axle load limit	4.000 kg	4.000 kg	6.300 kg
Rear axle load limit	5.600 kg / 6.800 kg	5.600 kg / 6.800 kg	11.000 kg (7.800 kg)
Engine	4-cylinder diesel engine, two phase turbo charging, intercooling and exhaust gas recirculation. Particle filter with SCR catalyst	6-cylinder diesel engine, two phase turbo charging, intercooling and exhaust gas recirculation. Particle filter with SCR catalyst	6-cylinder diesel engine, two phase turbo charging, intercooling and exhaust gas recirculation. Particle filter with SCR catalyst
Displacement	4.580 ccm	6.871 ccm	6.871 ccm
Performance	162 kW / 220 HP at 2.300 rpm, EURO VI - E	184 kW / 250 HP at 2.200 rpm, EURO VI - E	213 kW / 290 HP at 2.200 rpm, EURO VI - E
Torque	850 Nm at 1.300 - 1.800 rpm	1.050 Nm at 1.200 – 1.600 rpm	1.150 Nm at 1.200 - 1.700 rpm
Brake system	BrakeMatic electronic brake system, ABS, engine brake, heated compressed air dryer, ASR + ESP, emergency brake assistant, Easy Start	BrakeMatic electronic brake system, ABS, engine brake, heated compressed air dryer, ASR + ESP, emergency brake assistant, Easy Start	BrakeMatic electronic brake system, ABS, engine brake, heated compressed air dryer, ASR + ESP, emergency brake assistant, Easy Start
Steering	servo, steering wheel adjustable	servo, steering wheel adjustable	servo, steering wheel adjustable
Suspension	FA boosted, parabolic spring RA air suspension stabilisers	FA boosted, parabolic spring RA air suspension stabilisers	rolling bellows air suspension at FA + RA, stabilisers (parallel suspension FA)
Tyres equipment	235 / 75 R 17,5	235 / 75 R 17,5	285 / 70 R 19,5 (single wheels 385 / 55 R 22,5)
Gear box	6-speed automatic transmission, TipMatic®	12-speed automatic transmission, TipMatic®	12-speed automatic transmission, TipMatic®
Fuel tank	180 l Diesel / 35 l AdBlue	180 l Diesel / 35 l AdBlue	300 l Diesel / 35 l AdBlue
Electrical system	24 V, 2 x 88 Ah batteries	24 V, 2 x 88 Ah batteries	24 V, 2 x 88 Ah batteries
Alternator	28 V / 120 A	28 V / 120 A	28 V / 120 A
Anti-theft device	steering lock immobiliser	steering lock immobiliser	steering lock immobiliser
Miscellaneous	outside thermometer, cruise control, air condition drivers cab, multi function steering wheel, differential lock RA, lane guard assist, M+S snow tyres	outside thermometer, cruise control, air condition drivers cab, multi function steering wheel, differential lock RA, lane guard assist, M+S snow tyres	outside thermometer, cruise control, air condition drivers cab, multi function steering wheel, differential lock RA, lane guard assist, M+S snow tyres

MAN TGS 18.430 LL (four-wheeler) (TGS 26.430 LLL six-wheeler)	Mercedes-Benz Atego 1230 LL / 1330 LL / 1530 LL	Mercedes-Benz Actros 1843 LL (four-wheeler)	Mercedes-Benz Actros 2543 LLL (six-wheeler)
5.100 / 5.500 mm (5.100 mm + 1.350 mm)	4.460 / 4.760 / 4.960 / 5.360 mm	4.300 / 5.200 / 5.500 mm	5.200 + 1.350 mm
18.000 (26.000) kg	11.990 kg / 13.500 kg / 15.000 kg	18.000 kg	26.000 kg
7.500 kg	4.900 kg / 5.100 kg	8.000 kg	8.000 kg
11.500 kg (11.500 kg + 7.100 kg)	8.100 kg / 10.500 kg	11.500 kg	11.500 kg + 7.500 kg
6-cylinder diesel engine, two phase turbo charging, intercooling and exhaust gas recirculation. Particle filter with SCR catalyst	6-cylinder diesel engine, one phase turbo charging, intercooling and exhaust gas recirculation. Particle filter with SCR catalyst	6-cylinder diesel engine, turbo charging, intercooling and exhaust gas recirculation. Particle filter with SCR catalyst	6-cylinder diesel engine, turbo charging, intercooling and exhaust gas recirculation. Particle filter with SCR catalyst
12.419 ccm	7.698 ccm	10.700 ccm	10.700 ccm
316 kW / 430 HP at 1.800 rpm, EURO VI - E	220 kW / 299 HP at 2.200 rpm EURO VI - E	315 kW / 428 HP at 1.800 rpm EURO VI - E	315 kW / 428 HP at 1.800 rpm EURO VI - E
2.200 Nm at 930 - 1.350 rpm	1.200 Nm at 1.200 - 1.600 rpm	2.100 Nm at 1.100 rpm	2.100 Nm at 1.100 rpm
BrakeMatic electronic brake system, ABS, engine brake, heated compressed air dryer, ASR + ESP, emergency brake assistant, Easy Start	Electronic pneumatic brake system (EPB). ABS, ASR + ESP, compressed air convection dryer, High Performance Engine Brake, active brake assist	Electronic pneumatic brake system (EPB). ABS, ASR + ESP, compressed air convection dryer, High Performance Engine Brake, active brake assist	Electronic pneumatic brake system (EPB). ABS, ASR + ESP, compressed air convection dryer, High Performance Engine Brake, active brake assist
servo, steering wheel adjustable	servo, steering wheel adjustable	servo, steering wheel adjustable	servo, steering wheel adjustable
rolling bellows air suspension at FA + RA (FA + RA + TA), stabilisers	air suspension FA + RA stabilisers	air suspension FA + RA	air suspension FA + RA + trailing axle (TA)
355 / 50 R 22,5 315 / 60 R 22,5 (355 / 50 R 22,5)	285 / 70 R 19,5	355 / 50 R 22,5 295 / 315 / 60 R 22,5	355 / 50 R 22,5 315 / 60 R 22,5 / 355 / 50 R 22,5
12-speed automatic transmission, TipMatic®	8-speed automatic transmission, Mercedes-Benz Powershift 3	12-speed automatic transmission, Mercedes-Benz Powershift 3	12-speed automatic transmission, Mercedes-Benz Powershift 3
390 l Diesel / 60 l AdBlue	180 l Diesel / 25 l AdBlue	390 l Diesel / 60 l AdBlue	390 l Diesel / 60 l AdBlue
24 V, 2 x 175 Ah batteries	24 V, 2 x 100 Ah batteries	24 V, 2 x 170 Ah batteries	24 V, 2 x 170 Ah batteries
28 V / 120 A	28 V / 100 A	28 V / 100 A	28 V / 100 A
steering lock immobiliser	steering lock immobiliser	steering lock immobiliser	steering lock immobiliser
outside thermometer, cruise control, air condition drivers cab, multi function steering wheel, differential lock RA, lane guard assist, M+S snow tyres	outside thermometer, cruise control, air condition drivers cab, multi function steering wheel, differential lock RA, lane guard assist, M+S snow tyres	outside thermometer, cruise control, air condition drivers cab, multi function steering wheel, differential lock RA, lane guard assist, M+S snow tyres	outside thermometer, cruise control, air condition drivers cab, multi function steering wheel, differential lock RA, lane guard assist, M+S snow tyres

VARIO PERFECT

All vehicle prices are quoted **ex factory Bohmte** in the context of manufacturing a new vehicle.

* **Weight in working order means according to regulation (EU) Nr. 1230/2012:** unloaded weight including driver (75 kg), 90 % fuel, 100 % fresh water, 2 x 11 kg aluminium gas bottles, on board tool kit.

** **The payload according to regulation (EU) Nr. 1230/2012** results from the difference of the gross vehicle weight rating (GVWR) and the weight of the vehicle in working order including standard equipment.

*** **The number of seats with seat belt is depending on floor-plans.** Parenthesised data = optional equipment.

Optional equipment (extras / accessories) increases the weight in working order and reduces the payload. For the weight of the extra equipment please refer to this brochure.

The specified maximum permissible number of persons is depending on weight and axle load. It can be reduced when extras are mounted (= optional equipment / accessories), so in favour of the payload individual seats can not be used. If all seats shall be used, the payload has to be reduced partially. It is not allowed to exceed the permissible maximum weight (GVWR) and the maximum axle loads.

The load-carrying capacity is reduced by installing special equipment (= extras / extra equipment) and accessories. Moreover, the load-carrying capacity not only depends on the weight in working order, the actual vehicle mass, the weight of the accessories and the GVWR, but also on the respective axle loads. Prerequisites for using the full vehicle-technically possible payload is a corresponding relation to the axle load distribution.

The declaration of weight is approximately data. Variations of +/- 5 % in the range of craft tolerance are possible and allowed.

(1) The total height depends on the dimension/height of the storage room / garage / car garage

Type VARIO	Chassis	Wheel-base	GVWR	Weight in working order*	Payload** approx. (kg)	Seats with seatbelt ***
		(mm)	(kg)	(kg)		
PERFECT 800	MAN TGL 8.220 BL	3.900	8.800 (7.490)	6.900	1.960 (650)	3 (4)
PERFECT 850	MAN TGL 8.220 BL	4.200	8.800 (7.490)	7.100	1.760 (450)	3 (4)
PERFECT 900	MAN TGL 10.250 BL	4.500	10.000	7.690	2.370	3 (4)
PERFECT 900	MAN TGM 15.290 LL	4.425	15.000	8.900	6.160	3 (4)
PERFECT 900	MB Atego 1230 LL	4.460	11.990	8.870	3.180	3 (4)
PERFECT 900	MB Actros 1843 LL	4.300	18.000	11.490	6.570	3 (4)
PERFECT 900 4 x 4	MAN TGM 13.290 BL	4.250	14.100	10.100	4.060	3 (4)
PERFECT 950	MAN TGM 15.290 LL	4.725	15.000	9.520	5.540	3 (4)
PERFECT 950	MB Atego 1230 LL	4.760	11.990	9.490	2.560	3 (4)
PERFECT 950	MB Actros 1843 LL	4.600	18.000	11.490	6.570	3 (4)
PERFECT 1000	MAN TGM 15.290 LL	5.075	15.000	9.920	5.140	3 (4)
PERFECT 1000	MB Atego 1330 LL	4.960	13.500	9.900	3.660	3 (4)
PERFECT 1000	MB Actros 1843 LL	4.900	18.000	11.800	6.660	3 (4 / 5)
PERFECT 1050	MAN TGM 15.290 LL	5.425	15.000	10.520	4.540	3 (4 / 5)
PERFECT 1050	MB Atego 1530 LL	5.360	15.000	10.490	4.570	3 (4 / 5)
PERFECT 1050	MAN TGS 18.430 LL	5.100	18.000	12.190	5.870	3 (4 / 5)
PERFECT 1050	MB Actros 1843 LL	5.200	18.000	12.130	5.930	3 (4 / 5)
PERFECT 1100	MAN TGS 18.430 LL	5.500	18.000	12.390	5.650	3 (4 / 5)
PERFECT 1100	MB Actros 1843 LL	5.500	18.000	12.340	5.700	3 (4 / 5)
PERFECT 1200	MAN TGS 26.430 LLL	5.100 + 1.350	26.000	16.320	9.720	3 (4 / 5)
PERFECT 1200	MB Actros 2543 LLL	5.200 + 1.350	26.000	16.170	9.870	3 (4 / 5)

PRICES

PLEASE NOTE THE EXTENSIVE STANDARD EQUIPMENT OF OUR EXCLUSIVE MOTOR HOMES ⁽³⁾ The VARIOmobil vehicles include individual construction, driver assistance systems and many other high-quality details as standard. The detailed chassis equipment can be found on the previous pages „Chassis“ as well as on the following pages „Standard equipment“

Type VARIO	Chassis	Length	Width ⁽¹⁾	Height ⁽²⁾	Fresh-water-tank	Grey water tank	Black water tank	Vehicle basic price without tax	Vehicle basic price 19 % German tax included
		(mm)	(mm)	(mm)	(Liter)	(Liter)	(Liter)	(EURO)	(EURO)
PERFECT 800	MAN TGL 8.220 BL	8.200	2.530	3.550	300	200	200	492.764,71	586.390,00
PERFECT 850	MAN TGL 8.220 BL	8.600	2.530	3.550	350	250	200	501.655,46	596.970,00
PERFECT 900	MAN TGL 10.250 BL	9.000	2.530	3.550	400	250	250	521.546,22	620.640,00
PERFECT 900	MAN TGM 15.290 LL	9.000	2.530	3.700	400	250	250	544.495,80	647.950,00
PERFECT 900	MB Atego 1230 LL	9.000	2.530	3.760	400	250	250	538.042,02	640.270,00
PERFECT 900	MB Actros 1843 LL	9.200	2.530	3.850	400	250	250	639.302,52	760.770,00
PERFECT 900 4 × 4	MAN TGM 13.290 BL	9.000	2.530	3.800	400	250	250	587.411,76	699.020,00
PERFECT 950	MAN TGM 15.290 LL	9.500	2.530	3.700	400	250	250	558.621,85	664.760,00
PERFECT 950	MB Atego 1230 LL	9.500	2.530	3.760	400	250	250	552.159,66	657.070,00
PERFECT 950	MB Actros 1843 LL	9.500	2.530	3.700	400	250	250	657.983,19	783.000,00
PERFECT 1000	MAN TGM 15.290 LL	9.990	2.530	3.700	400	300	250	593.361,34	706.100,00
PERFECT 1000	MB Atego 1330 LL	9.990	2.530	3.760	400	300	250	560.739,50	667.280,00
PERFECT 1000	MB Actros 1843 LL	9.990	2.530	3.800	400	300	250	691.680,67	823.100,00
PERFECT 1050	MAN TGM 15.290 LL	10.500	2.530	3.800	450	300	250	627.747,90	747.020,00
PERFECT 1050	MB Atego 1530 LL	10.500	2.530	3.800	450	300	250	621.294,12	739.340,00
PERFECT 1050	MAN TGS 18.430 LL	10.500	2.530	3.900	450	300	250	726.453,78	864.480,00
PERFECT 1050	MB Actros 1843 LL	10.500	2.530	3.900	450	350	300	734.470,59	874.020,00
PERFECT 1100	MAN TGS 18.430 LL	11.000	2.550	3.950	500	350	300	871.873,95	1.037.530,00
PERFECT 1100	MB Actros 1843 LL	11.000	2.550	3.990	500	350	300	879.823,53	1.046.990,00
PERFECT 1200	MAN TGS 26.430 LLL	12.000	2.550	3.990	500	400	300	970.722,69	1.155.160,00
PERFECT 1200	MB Actros 2543 LLL	12.000	2.550	3.990	500	400	300	978.747,90	1.164.710,00

FLOOR PLANS

Perfect 800 A	Perfect 800 B single beds	Perfect 850 A1	Perfect 850 A2	Perfect 850 B single beds	Perfect 850 C
---------------	------------------------------	----------------	----------------	------------------------------	---------------

VARIO PERFECT

100 % PLANNING FREEDOM in layout, equipment and design.
Experience more examples of individual interiors at www.vario-mobil.com.

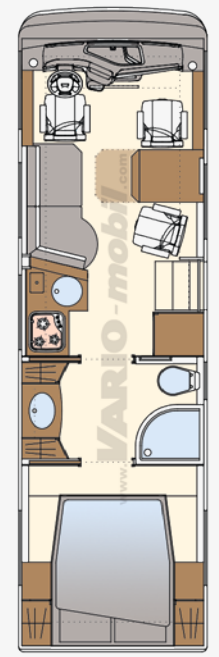
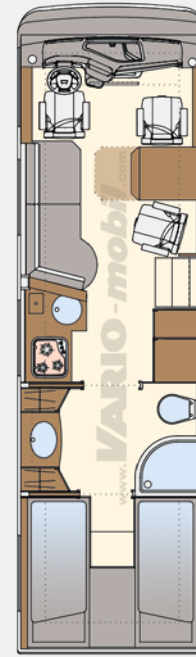
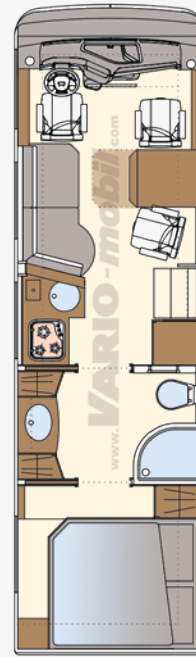
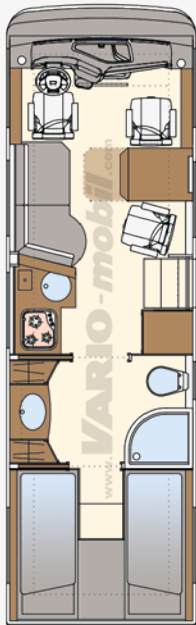
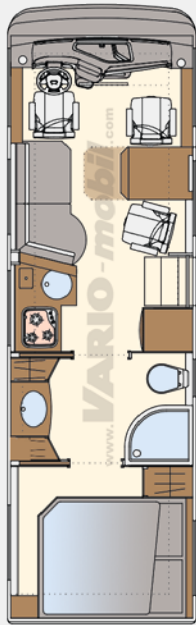

A VARIOmobil is the completion of more than four decades acquired expertise in the HIGH-END vehicle construction. Experience unique MANUFACTURY construction and 100% planning freedom in layout, equipment and design.

The Slide Out System is available as an option for the VARIO Perfect from 9 m and has a pneumatic sealing system, surface heating in the roof and front sides as well as a reinforced tubular frame construction of the chassis. Up to three or four extendable oriels can be installed in one vehicle.

Special requests do not exist for us, but wishes that we would like to implement to your satisfaction. We manufacture residential and business mobiles, 100% custom made and offer 100% choice in every configuration detail, harmoniously matched in function, quality and design.

FLOOR PLANS

Perfect 900 A Slide Out	Perfect 900 B single beds Slide Out	Perfect 900 C	Perfect 950 B single beds	Perfect 950 C Slide Out	Perfect 1000 A
----------------------------	--	---------------	------------------------------	----------------------------	----------------

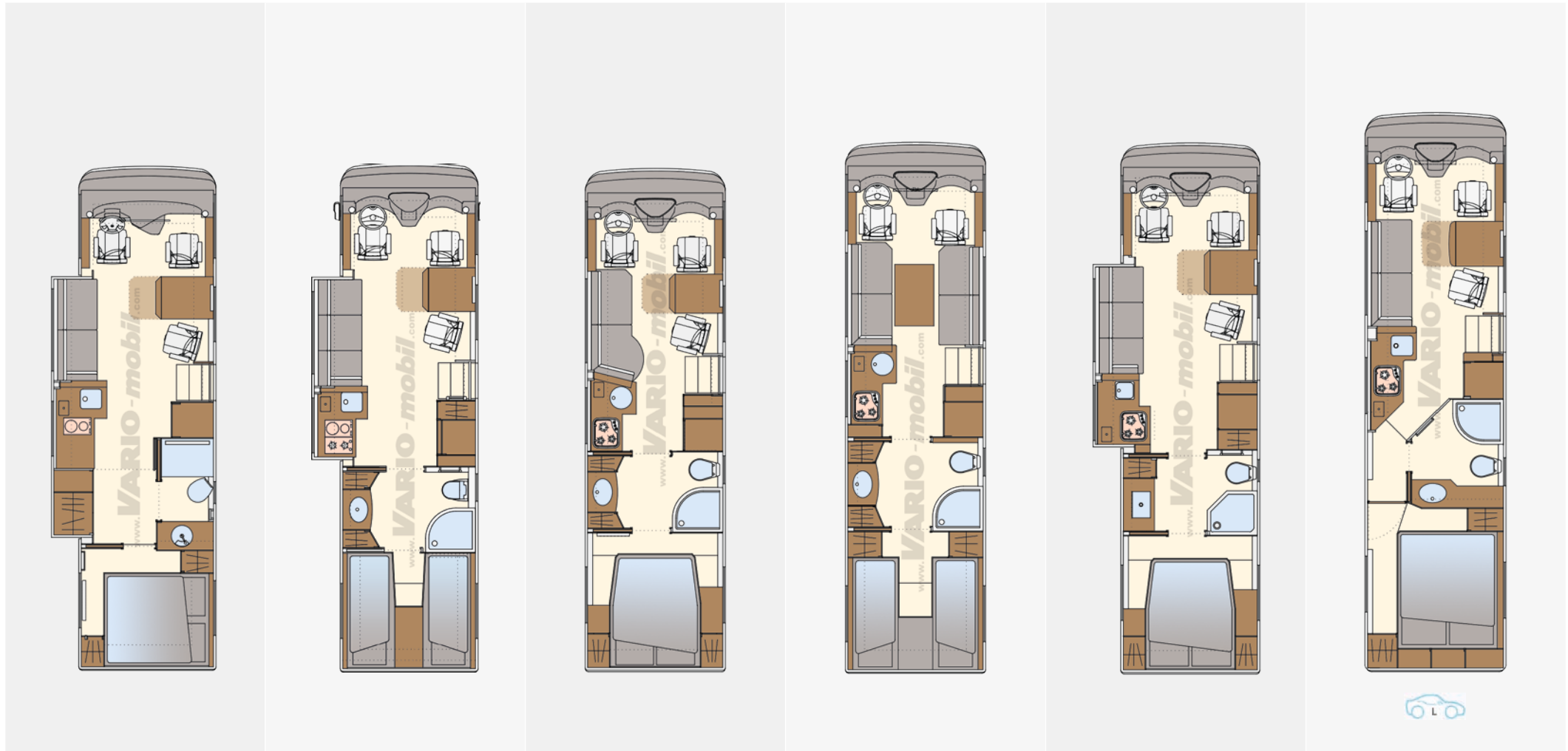

Please note that the illustrations shown can only give you a small insight into possible floor plan ideas. Of course, we will develop the best individual desired floor plan for you and with you.

The floor plan solutions shown here may include special equipment.

Your VARIOmobil is equipped with XXL storage capacities. The very large rear garage is illuminated and lined with easy-care needle felt and can accommodate all the things you would like to take along on a long journey. **100 % CUSTOM MADE** means: every millimeter of free space in your dream vehicle can be designed individually. Each rear garage is individually adapted to your desired auxiliary vehicles. From bicycles, scooters, motorcycles to quads. Ask us! Other types of auxiliary vehicles can be taken on board as an option.

FLOOR PLANS

Perfect 1000 A1
Slide Out

Perfect 1000 A2
Slide Out

Perfect 1000 C
Slide Out

Perfect 1050 A

Perfect 1050 A1
Slide Out

Perfect 1050 A2
Slide Out

100 % PLANNING FREEDOM in layout, equipment and design.
Experience more examples of individual interiors at www.vario-mobil.com.

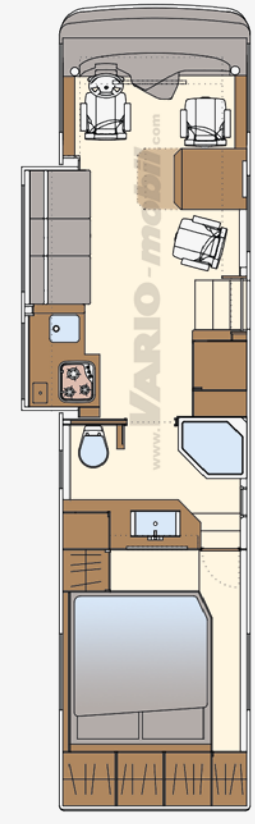
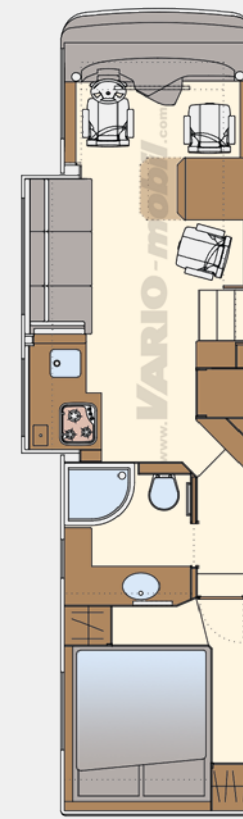
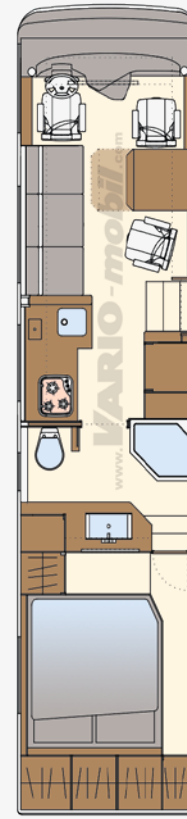
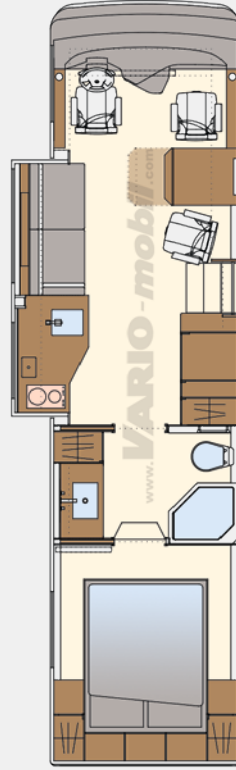
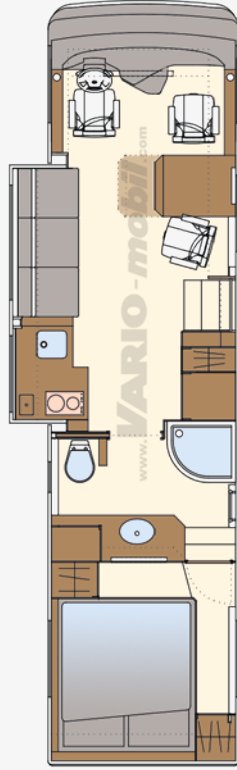
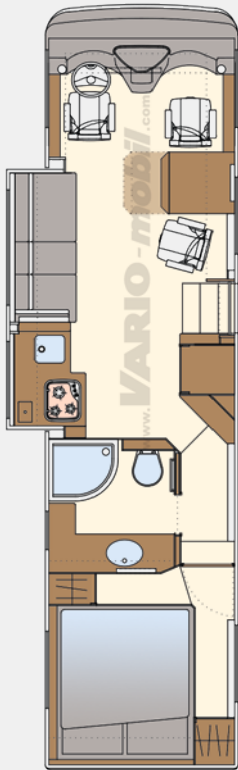

Hydraulically extendable Slide Outs

Enjoy the best days of the year in an absolute generous atmosphere. Extendable bay windows - also called Slide Out - increase the living room and bedroom of your motorhome for a certain plus in comfort.

Each VARIOmobil is individually handcrafted with great attention to detail. Here, you will find proven floor plan ideas for exclusive motorhomes that leave no comfort behind. The car symbol indicates that a companion vehicle can be taken on board starting from a vehicle length of 10 meters.

Maximum width. Sophisticated technology.

The spacious kitchen with adjoining comfortable lounge, the bed and / or another seating area in the bedroom can be extended with hydraulically operated slide outs. **All underbody storage spaces are fully preserved.**

FLOOR PLANS

Perfect 1100 Slide Out	Perfect 1100 Double Slide Out	Perfect 1200 Slide Out	Perfect 1200 Double Slide Out	Perfect 1200 Triple Slide Out	Perfect 1200 Quadro Slide Out
---------------------------	----------------------------------	---------------------------	----------------------------------	----------------------------------	----------------------------------

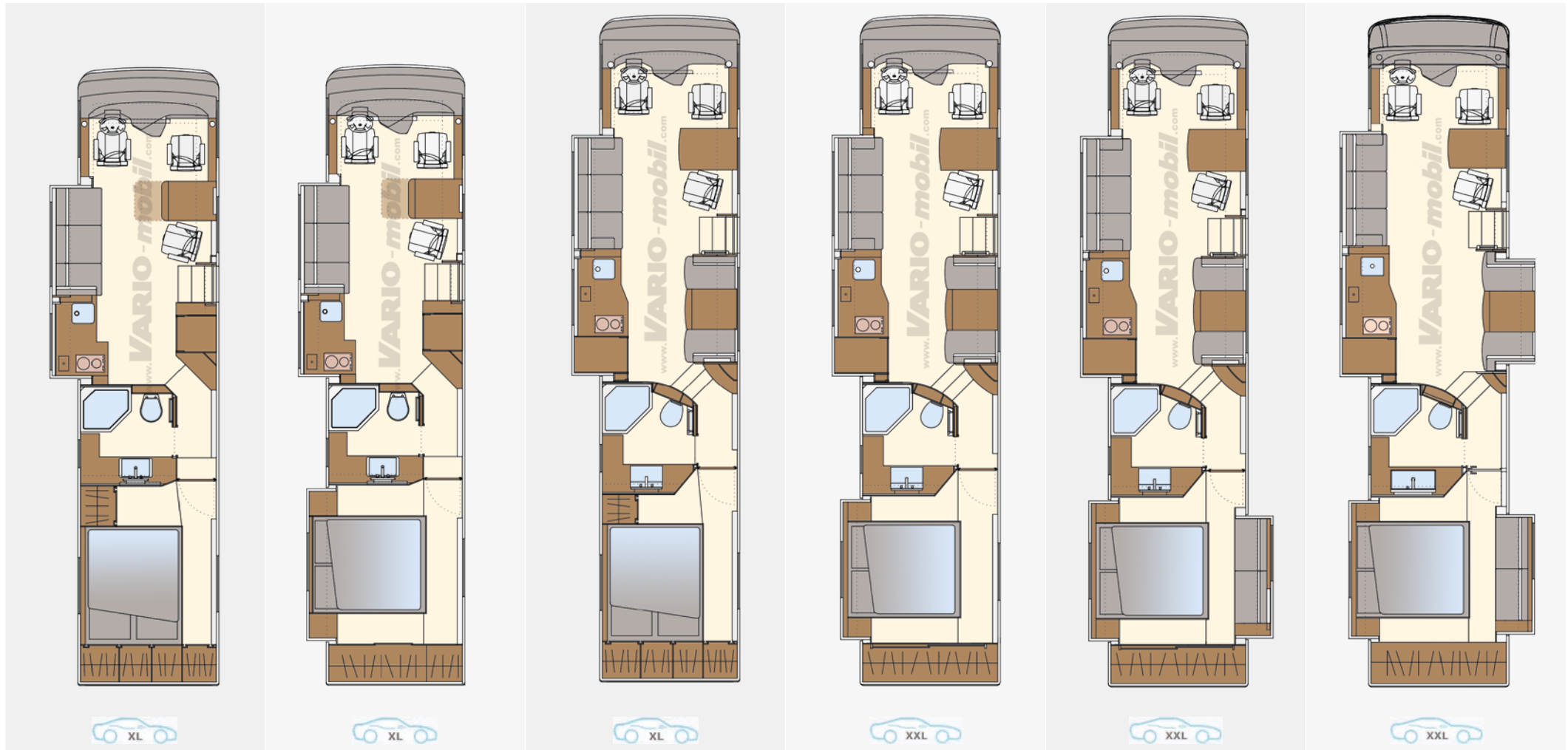

Please note!

The illustrations are possible floor plan ideas. Of course, we develop your individual layout on request. The ground plans above may be equipped with optional features.

Your **VARIOmobil** is equipped with XXL storage capacities. The very large rear garage is illuminated and lined with easy-care needle felt and can accommodate all the things you would like to take along on a long journey. **100 % CUSTOM MADE** means: each motor home and each car garage will be individually adjusted to your own customer car. Ask us! Additional types of passenger cars can be taken on board.



Garage e.G. for Smart for two



Garage e.G. for Smart for two, Mini Cooper, Fiat 500 / Abarth 595, VW up



Garage e.G. for Mini-Cooper, Porsche 911, Boxster, BMW 1er, BMW Z 4, Mercedes-Benz A-Klasse, SL, SLC

Code	Description	kg	800	850	900	950	1000	1050	1100	1200	Net price EURO	Price / EURO incl. 19 % German tax
Chassis MAN TGL / TGM												
S	MAN TGL 8.220 BL, 4 cylinder diesel engine with two-stage turbocharging, intercooling and exhaust gas recirculation. Diesel particulate filter with SCR catalytic converter, 4.580 ccm, 162 kW / 220 hp at 2.300 rpm EURO VI, 850 Nm at 1.300 - 1.800 rpm, electronic brake system BrakeMatic, ABS, engine brake, compressed air convection dryer. ASR + ESP, brake actuated by separate controlled rocker-arm facility (EVB), V-constant regulation, emergency brake assist, lane guard assistant, FA boosted, parabolic suspension, RA air suspension, stabilizers, 6-speed automatic transmission, TipMatic®, steering wheel lock with immobilizer		■	■								
O	C200 Engine variation MAN TGL 8.250, 6 cylinder diesel engine with two-stage turbocharging, intercooling and exhaust gas recirculation. Diesel particulate filter with SCR catalytic converter, 6.871 ccm, 184 kW / 250 hp at 2.200 rpm EURO VI, 1.050 Nm at 1.200 – 1.600 rpm, electronic brake system BrakeMatic, ABS, engine brake, compressed air convection dryer. ASR + ESP, brake actuated by separate controlled rocker-arm facility (EVB), V-constant regulation, emergency brake assist, lane guard assistant, FA boosted, parabolic suspension, RA air suspension, stabilizers, 12-speed automatic transmission, TipMatic®, steering wheel lock with immobilizer	370	□	□							8.121,01	9.664,00
S	MAN TGL 10.250, 6 cylinder diesel engine with two-stage turbocharging, intercooling and exhaust gas recirculation. Diesel particulate filter with SCR catalytic converter, 6.871 ccm, 184 kW / 250 hp at 2.200 rpm EURO VI, 1.050 Nm 1.200 – 1.600 rpm				■	■						
S	MAN TGM 13.290 BL 4x4, 6 cylinder diesel engine with two-stage turbocharging, intercooling and exhaust gas recirculation. Diesel particulate filter with SCR catalytic converter, 6.871 ccm, 213 kW / 290 hp at 2.200 rpm EURO VI - E, 1,150 Nm at 1,200 – 1,700 rpm, BrakeMatic electronic brake system, ABS, engine brake, heated compressed air dryer. ASR + ESP, emergency brake assistant, Easy Start, lane departure warning, FA boostet, parabolic suspension, RA air suspension, stabilizers, automated 12-speed gearbox, TipMatic®, steering wheel lock with immobilizer, single-wheel drive				■	■						
S	MAN TGM 15.290 BL, 6-cylinder diesel engine with two-stage turbocharger, charge air cooling and exhaust gas recirculation. Particle filter with SCR catalytic converter, 6,871 ccm, 213 kW / 290 hp at 2,200 rpm EURO VI - E, 1,150 Nm at 1,200 - 1,700 rpm, BrakeMatic electronic brake system, ABS, engine brake, heated compressed air dryer. ASR + ESP, emergency brake assistant, easy start, lane departure warning, FA and RA rolling bellows air suspension, stabilizers, automated 12-speed gearbox, TipMatic®, steering wheel lock with immobilizer				■	■	■	■				
O	C202 Air suspension FA MAN TGL 8.220-10.250, body lifting system	50	□	□	□						14.424,37	17.165,00
S	Diesel tank 180 l / 20 l AdBlue TGL		■	■	■							
S	Diesel tank 300 l / 20 l AdBlue TGM				■	■	■	■				
S	C214 Differential lock RA MAN TGL / TGM		■	■	■	■	■	■				
S	P2GC Leather multifunction steering wheel		■	■	■	■	■	■				
S	P1ZH high-beam assistant		■	■	■	■	■	■				
S	P1ZE Driving lights switch automatically, with light sensor		■	■	■	■	■	■				
S	P1TF MAN Easy Start (starting aid and anti-roll device)		■	■	■	■	■	■				
S	P3L2 Instrument cluster Professional, 12.3" color display		■	■	■	■	■	■				
S	P2LZ MAN Mediasystem Navigation Professional 12.3" infotainment system with 12.3" monitor, truck navigation with online traffic, radio with FM / KW / MW / LW, digital radio DAB+, Bluetooth music streaming, hands-free functionality for two mobile phones, AUX IN / USB, speakers, antenna		■	■	■	■	■	■				
S	C244 Air condition drivers cabin MAN TGL / TGM		■	■	■	■	■	■				
S	P1TP Cruise control ACC, distance-controlled MAN TGL / TGM		■	■	■	■	■	■				
O	P2F5 Storage table on the passenger side	2	□	□	□	□	□	□			686,55	817,00
O	C225 Wheel spacer front / rear axle (+ 140 / + 140 mm) TGL 8.220 - 10.250	78	□	□	□	□	□	□			4.760,50	5.665,00
O	P0OW Alloy rims ALCOA Dura Bright 6,75 x 17,5, 6-fold MAN TGL 8.220-10.250	-54	□	□	□						3.201,68	3.810,00
O	P1UC Tire pressure monitoring system (TPM) MAN TGM	3	□	□	□	□	□	□			1.108,40	1.319,00
O	C880 Load variant TGL 10.220 for series 8.220		□	□							5.516,81	6.565,00
O	P2O2 Additional hot water heating 4 kW, cab (MAN TGL / TGM)	8	□	□	□	□	□	□			2.081,51	2.477,00

	Code	Description	kg	800	850	900	950	1000	1050	1100	1200	Net price EURO	Price / EURO incl. 19% German tax
Chassis MAN TGS													
S		MAN TGS 18.430 LL, two-axle chassis 6-cylinder diesel engine with two-stage turbocharging, intercooling and exhaust gas recirculation. Particle filter with SCR catalytic converter, 12,419 ccm, 316 kW / 430 hp at 1,800 rpm, EURO VI - E, 2,200 Nm at 930 - 1,350 rpm, electronic brake system, BrakeMatic, ABS, engine brake, heated compressed air dryer. ASR + ESP, Emergency brake assistant, Easy Start, lane departure warning, rolling bellows air suspension on FA + RA, stabilizers, automated 12-speed gearbox, TipMatic®, steering wheel lock with immobilizer							■	■			
S		MAN TGS 26.430 LLL, three-axle chassis with steered trailing axle (NLA) 6-cylinder diesel engine with two-stage turbocharging, intercooling and exhaust gas recirculation. Particle filter with SCR catalytic converter, 12,419 ccm, 316 kW / 430 hp at 1,800 rpm, EURO VI - E, 2,200 Nm at 930 - 1,350 rpm, Electronic brake system, BrakeMatic, ABS, engine brake, heated compressed air dryer, ASR + ESP, Emergency brake assistant, Easy Start, lane departure warning, rolling bellows air suspension on FA / RA / NLA, stabilizers, automated 12-speed gearbox, TipMatic®, steering wheel lock with immobilizer											
O	C878	Engine variant 375 kW / 510 hp, 2,600 Nm torque							□	□	□	7.836,97	9.326,00
S		390 l Diesel / 60 l AdBlue							■	■	■		
S	C246	Differential lock RA MAN TGS							■	■	■		
S	C267	Automatic climate control in MAN TGS cab							■	■	■		
S	P2GC	Leather multifunction steering wheel							■	■	■		
S	P1TT	Lane Departure Warning LDW							■	■	■		
S	P1U3	Emergency Brake Assist EBA							■	■	■		
S	P3L2	Instrument cluster Professional, 12.3" color display							■	■	■		
S	P2LZ	MAN media system, navigation professional 12.3" infotainment system with 12.3" monitor, truck navigation with online traffic, radio with FM / KW / MW / LW, digital radio DAB+, Bluetooth music streaming, hands-free functionality for two mobile phones, AUX IN / USB, speakers, antenna							■	■	■		
S	P1ZH	High-beam assistant							■	■	■		
S	P1ZE	Driving lights switch automatically, with light sensor							■	■	■		
S	P1TQ	Cruise control ACC, distance-controlled							■	■	■		
O	0P22	6 x aluminum wheels ALCOA Dura Bright 11.75 x 22.5" for front / 9" x 22.5", 4-fold for rear	-100						□	□		5.801,68	6.904,00
O	0P23	8 x aluminum wheels ALCOA Dura Bright 11.75 x 22.5" for FA / 9" x 22.5" RA, 11.75 x 22.5" NLA	-140								□	8.056,30	9.587,00
O	P4FJ	Cruise control function MAN Efficient Cruise, regulated depending on the terrain							□	□	□	3.074,79	3.659,00
O	P1TV	Lane return assistant LRA MAN TGS							□	□	□	1.057,98	1.259,00
O	P5VT	Retarder MAN TGS	150						□	□	□	9.489,92	11.293,00
O	P2F5	Storage table on the passenger side	2						□	□	□	686,55	817,00
O	P2I7	Color ambience 'Desert Beige' for cab / dashboard inside							□	□	□	409,24	487,00
O	P1UC	Tire pressure monitoring system (TPM) MAN TGS	3						□	□	□	1.108,40	1.319,00
O	P2O4	Additional water heating 6 kW, driver's cab	10						□	□	□	3.281,51	3.905,00
O	P2HJ	Drawer, center section in instrument panel MAN TGS	2						□	□	□	166,39	198,00

Code	Description	kg	800	850	900	950	1000	1050	1100	1200	Net price EURO	Price / EURO incl. 19 % German tax
Chassis Mercedes-Benz Atego												
S	MB Atego 1230 LL / 1330 LL / 1530 LL, 6-cylinder diesel engine with one-stage turbocharging, intercooling and exhaust gas recirculation. Particulate filter with SCR catalytic converter, 7.698 ccm, 220 kW / 299 hp at 2.200 rpm, EURO VI - E, 1.200 Nm 1.200 - 1.600 rpm, electropneumatic braking system (EPB) with ABS, ASR and ESP, compressed air convection dryer, high performance engine brake, emergency brake assist, lane guard assist, full air suspension FA and RA, stabilizers, 8-speed automatic transmission, Mercedes-Benz Powershift 3 steering wheel lock with immobilizer				■	■	■	■				
S	C113 Differential lock RA				■	■	■	■				
S	C150 Cruise control MB Atego				■	■	■	■				
S	CD6F Air conditioning driver's seat				■	■	■	■				
S	C918 Atego safety package: Lane Keeping Assist + Active Brake Assist (emergency braking assistant)				■	■	■	■				
S	CJ2B MB CD radio Bluetooth, 24 V, FM tuner with RDS-EON, MW, LW, KW, CD-Player, mini USB front port, Aux front port, Bluetooth hands free speaking, 4 x 20 W, 4 x speakers, roof antenna, operation via steering wheel and directly on the device				■	■	■	■				
S	CD0A Multifunctional steering wheel leather				■	■	■	■				
S	Diesel tank 180 l / 25 l AdBlue				■	■	■	■				
O	C600 Diesel tank 290 l / 35 l AdBlue	130			☐	☐	☐	☐			2.121,01	2.524,00
O	CR7K Alloy rims ALCOA DURA BRIGHT, 7,5 x 19,5", 6-fold, MB Atego 1230-1530	-60			☐	☐	☐	☐			4.210,08	5.010,00
O	C919 Wheel spacer FA (+ 132 mm), MB Atego 1224 - 1530	10			☐	☐	☐	☐			1.500,00	1.785,00
O	C923 MB Atego 1330 load variant 13,5 t (5,1/9,3) for standard 1230				☐	☐					5.276,47	6.279,00
O	C924 MB Atego 1530 load variant 15,0 t (5,1/10,5) for standard 1330						☐				5.276,47	6.279,00
Chassis Mercedes-Benz Actros												
S	MB Actros 1843 LL, fourwheel chassis 6 cylinder diesel engine with turbo charging, intercooling and exhaust gas recirculation. Diesel particulate filter with SCR catalytic converter, 10.700 ccm, 315 kW / 428 hp at 1.800 rpm EURO VI - E, 2.100 Nm at 1.100 rpm, electronic pneumatic brake system (EPB). ABS, ASR and ESP, compressed air convection dryer, high performance engine brake, active brake assist, lane guard assist, full air suspension FA and RA, 12-speed automatic transmission Mercedes-Benz PowerShift 3, steering lock with immobiliser				■	■	■	■	■			
S	MB Actros 2543 LLL, sixwheel chassis with steered trailing axle (TA) 6 cylinder diesel engine with turbo charging, intercooling and exhaust gas recirculation. Diesel particulate filter with SCR catalytic converter, 10.700 ccm, 315 kW / 428 hp at 1.800 rpm EURO VI, 2.100 Nm at 1.100 rpm, electronic pneumatic brake system (EPB). ABS, ASR and ESP, compressed air convection dryer, high performance engine brake, active brake assist, lane guard assist, full air suspension FA, RA and TA, 12-speed automatic transmission Mercedes-Benz PowerShift 3, steering lock with immobiliser									■		
O	C210 Engine variant MB Actros 1846 – 335 kW (455 hp), 10,7 l Motor, 2.200 Nm (for 1843)				☐	☐	☐	☐	☐		3.535,29	4.207,00
O	C211 Engine variant MB Actros 2553 – 390 kW (530 hp), 12,8 l Motor, 2.500 Nm (for 2543)	285								☐	15.536,13	18.488,00
O	C212 Engine variant MB Actros 1835 LL, two-axle chassis 6-cylinder diesel engine with turbocharging, intercooling and exhaust gas recirculation, particle filter with SCR catalytic converter, 7,698 ccm, 260 kW / 354 hp at 1,800 rpm EURO VI - E, 7, 7 l engine, 1,400 Nm at 1,200 - 1,600 rpm, electropneumatic brake system (EPB) with ABS, ASR and ESP, heated compressed air dryer, high performance engine brake, emergency brake assistant, lane departure warning system, air suspension on FA + HA, automated 8-speed gearbox Mercedes-Benz PowerShift 3, steering wheel lock with immobilizer (reduced price for MB Actros 1843 series)	-150			☐	☐	☐	☐	☐		-10.500,00	-12.495,00

	Code	Description	kg	800	850	900	950	1000	1050	1100	1200	Net price EURO	Price / EURO incl. 19% German tax
Chassis Mercedes-Benz Actros													
S		Differential lock RA				■	■	■	■	■	■		
S	C600	Diesel tank 290 l / 35 l AdBlue	130			■	■	■					
S		Diesel tank 390 l / 60 l AdBlue							■	■	■		
S	CD6G	Automatic climate control in the cockpit				■	■	■	■	■	■		
S	CCS1H	Lane Keeping Assist + Active Brake Assist (Emergency Brake Assist)				■	■	■	■	■	■		
S	CGOT	MB Predictive Powertrain Control supports the adaptive cruise control with GPS data from the navigation system considering the topography				■	■	■	■	■	■		
S		Cruise control				■	■	■	■	■	■		
S	CJ6C	Multimedia cockpit, interactive with 12.3" touchscreen, incl. (CJ2E) FM Tuner with RDS-EON, MW, LW, KW, Mini USB / AUX front port, Bluetooth Hands-free kit, 2 x 20 W, 2 speakers, roof antenna, operation via steering wheel and directly on the device (CJ2U) Truck Navigation with dynamic route guidance under consideration of length/width/height and weight Life Traffic function for 27 countries (max. 3 years free) Bluetooth hands-free function (CS10) Traffic Sign Assistant (CJ2G) Digital Radio - DAB+											
S	CD0A	Multifunctional steering wheel leather				■	■	■	■	■	■		
S	CCS1L	Distance Control Assist with Stop and Go function in combination with Active Brake Assist 5 - pedestrian detection				■	■	■	■	■	■		
S	CS3C	Drivers airbag Perfect				■	■	■	■	■	■		
○	CS1J	Active Drive Assist, semi-automated driving in all speed ranges with lateral and longitudinal intervention - the vehicle steers itself in the lane including electrohydraulic steering	10			□	□	□	□	□		5.962,18	7.095,00
○	CB3H	Secondary water retarder	72			□	□	□	□	□		5.697,49	6.780,00
○	CD5E	6 x ALCOA Dura Bright aluminum wheels 11.75 x 22.5" front / 9" x 22.5" rear	-105			□	□	□	□	□		5.006,72	5.958,00
○	CD6E	8 x ALCOA Dura Bright aluminum wheels 11.75 x 22.5" front / 9" x 22.5" rear / 11.75 x 22.5" for TA	-140								□	6.792,44	8.083,00
○	CS1Y	Tire pressure control Actros 1843	3			□	□	□	□	□		1.668,91	1.986,00
○	CS1Z	Tire pressure control Actros 2543	3								□	2.319,33	2.760,00
○	C442	RUDMATIK Snow sling chain for drive axle	40			□	□	□	□	□	□	7.180,67	8.545,00
○	CD7V	Folding table dashboard passenger side	2			□	□	□	□	□	□	581,51	692,00
○	CD6N	Actros hot water heating for cab and engine, 24 V, 9 kW (together with eE241)				□	□	□	□	□	□	5.636,97	6.708,00
○	CS1X	Active Sideguard Assist, active turning assistant with emergency break in critical blind spot situations	3			□	□	□	□	□	□	5.180,67	6.165,00
○	CD5O	"StyleLine" design Actros dashboard				□	□	□	□	□	□	1.167,23	1.389,00
○	CD6O	"TrendLine" design Actros dashboard				□	□	□	□	□	□	1.167,23	1.389,00

Code	Description	kg	800	850	900	950	1000	1050	1100	1200	Net price EURO	Price / EURO incl. 19 % German tax
CHASSIS (quod vide detailed chassis equipment)												
S	Engine compartment with additional sound absorption		■	■	■	■	■	■	■	■		
S	Electronic braking systems, stabilisers at front- and rear axles boosted		■	■	■	■	■	■	■	■		
S	Anti blocking system (ABS), ASR, ESP		■	■	■	■	■	■	■	■		
S	Stainless steel wheel covers all around		■	■	■	■	■	■	■	■		
S	Winter tyres at all axles		■	■	■	■	■	■	■	■		
S	Multi function steering wheel, servo steering, steering column adjustable, outside thermometer		■	■	■	■	■	■	■	■		
S	Drivers cabin air-conditioned		■	■	■	■	■	■	■	■		
S	Cruise control		■	■	■	■	■	■	■	■		
S	Anti-theft device / electronic immobilizer		■	■	■	■	■	■	■	■		
S	Original-frame lowering device/-extension for huge towing capacity		■	■	■	■	■	■	■	■		
S	Under body wax coating at the frame, drivers platform raised, planar floor		■	■	■	■	■	■	■	■		
S	LED main headlights, LED high beam headlights, LED fog lights, LED daytime running lights		■	■	■	■	■	■	■	■		
S	SKA comfortable drivers- and co-drivers seat with integrated 3-point belt, head- and armrests, adjustable in height and inclination, seat surface extendable, pneumatic lumbar support, turnable, upholstered version		■	■	■	■	■	■	■	■		
O	D014	Splash guards (front / rear end)	8	<input type="checkbox"/>	<input type="checkbox"/>	<input type="checkbox"/>	<input type="checkbox"/>	<input type="checkbox"/>	<input type="checkbox"/>	<input type="checkbox"/>	1.021,01	1.215,00
O	C296	Repaint parts of the dashboard, colour: leather seats		<input type="checkbox"/>	<input type="checkbox"/>	<input type="checkbox"/>	<input type="checkbox"/>	<input type="checkbox"/>	<input type="checkbox"/>	<input type="checkbox"/>	521,01	620,00
O	C298	Dashboard covered with leather, bicolour design (MAN/MB Atego)	10	<input type="checkbox"/>	<input type="checkbox"/>	<input type="checkbox"/>	<input type="checkbox"/>	<input type="checkbox"/>	<input type="checkbox"/>	<input type="checkbox"/>	7.855,46	9.348,00
O	C299	Dashboard and center console covered with leather, bicolour design (MB Actros)	15		<input type="checkbox"/>	<input type="checkbox"/>	<input type="checkbox"/>	<input type="checkbox"/>	<input type="checkbox"/>	<input type="checkbox"/>	9.963,02	11.865,00
O	E501	Twin video rear vision colour monitoring system, dust protection lid, 7" LCD colour screen, IR-LED/low distance camera	7	<input type="checkbox"/>	<input type="checkbox"/>	<input type="checkbox"/>	<input type="checkbox"/>	<input type="checkbox"/>	<input type="checkbox"/>	<input type="checkbox"/>	2.757,98	3.282,00
O	E504	Reverse drive warning system acoustic		<input type="checkbox"/>	<input type="checkbox"/>	<input type="checkbox"/>	<input type="checkbox"/>	<input type="checkbox"/>	<input type="checkbox"/>	<input type="checkbox"/>	200,00	238,00
O	E506	360° all-round view camera system with 10" monitor, 4 x HD cameras with a viewing angle of 180° (horizontal), individual images	6	<input type="checkbox"/>	<input type="checkbox"/>	<input type="checkbox"/>	<input type="checkbox"/>	<input type="checkbox"/>	<input type="checkbox"/>	<input type="checkbox"/>	6.569,75	7.818,00
O	D004	VARIO-MirrorEye, camera-based mirror replacement system, 12.3" / 15" / 7" monitors on the A-pillars, outside cameras left/right (replace the main mirror, the wide-angle mirror and the approach mirror)		<input type="checkbox"/>	<input type="checkbox"/>	<input type="checkbox"/>	<input type="checkbox"/>	<input type="checkbox"/>	<input type="checkbox"/>	<input type="checkbox"/>	9.426,05	11.217,00
O	C311	Double air horn	4	<input type="checkbox"/>	<input type="checkbox"/>	<input type="checkbox"/>	<input type="checkbox"/>	<input type="checkbox"/>	<input type="checkbox"/>	<input type="checkbox"/>	705,88	840,00
O	C996	Compressed air connection in under storage room	2	<input type="checkbox"/>	<input type="checkbox"/>	<input type="checkbox"/>	<input type="checkbox"/>	<input type="checkbox"/>	<input type="checkbox"/>	<input type="checkbox"/>	633,61	754,00
O	R002	Hitch 3.500 kg for GVWR = 7.490 kg (only 3.000 kg if GVWR < 10.000 kg), outlet 12 V	20	<input type="checkbox"/>	<input type="checkbox"/>						2.884,03	3.432,00
O	R003	Hitch 3.500 kg for GVWR < 26.000 kg, outlet 12 V	30			<input type="checkbox"/>	<input type="checkbox"/>	<input type="checkbox"/>	<input type="checkbox"/>	<input type="checkbox"/>	3.736,97	4.447,00
O	R004	Hitch removable 3.000 kg, outlet 12 V	30	<input type="checkbox"/>	<input type="checkbox"/>	<input type="checkbox"/>	<input type="checkbox"/>	<input type="checkbox"/>	<input type="checkbox"/>	<input type="checkbox"/>	4.283,19	5.097,00
O	R005	Pin trailer hitch with continuous air brakes, trailer control unit, ABS / 24 V sockets, compressed air connections, trailer load up to 13.000 kg (depending on model)	180			<input type="checkbox"/>	<input type="checkbox"/>	<input type="checkbox"/>	<input type="checkbox"/>	<input type="checkbox"/>	11.504,20	13.690,00
O	R102	4 x hydraulic jacks for GVWR 6.000 - 9.500 kg, double effective cylinder, autolevel, additional manual emergency operating system	90	<input type="checkbox"/>	<input type="checkbox"/>						12.328,57	14.671,00
O	R103	4 x hydraulic jacks for GVWR 9.500 - 11.990 kg, double effective cylinder, autolevel, in case of need manual operation	120	<input type="checkbox"/>	<input type="checkbox"/>	<input type="checkbox"/>					14.375,63	17.107,00
O	R104	4 x hydraulic jacks for GVWR 12.000 - 26.000 kg, double effective cylinder, in case of need manual operation	220			<input type="checkbox"/>	<input type="checkbox"/>	<input type="checkbox"/>	<input checked="" type="checkbox"/>	<input checked="" type="checkbox"/>	19.644,54	23.377,00
O	R105	Load distribution plates (4) with loops 400 x 400 mm for hydraulic supports, loose	24	<input type="checkbox"/>	<input type="checkbox"/>	<input type="checkbox"/>	<input type="checkbox"/>	<input type="checkbox"/>	<input type="checkbox"/>	<input type="checkbox"/>	310,08	369,00
O	R107	Stainless steel bracket support plates under rear storage compartment / side hatch	7	<input type="checkbox"/>	<input type="checkbox"/>	<input type="checkbox"/>	<input type="checkbox"/>	<input type="checkbox"/>	<input type="checkbox"/>	<input type="checkbox"/>	615,13	732,00

	Code	Description	kg	800	850	900	950	1000	1050	1100	1200	Net price EURO	Price / EURO incl. 19 % German tax
BODYWORK													
S		Full insulated self supporting body, glass fibre reinforced plastic (GRP), formed components seamless integrated		■	■	■	■	■	■	■	■		
S		Corner joint profiles without cold bridge		■	■	■	■	■	■	■	■		
S		Front end hood GRP, with service / front flap, seamlessly integrated into the side walls		■	■	■	■	■	■	■	■		
S		Omnibus panorama windshield, laminated glass, toned, glued into the body, thermal insulation glazing ,Pilkington Opticool' reduces special solar protection by 56% of the solar radiation.		■	■	■	■	■	■	■	■		
S		Spoiler bumper with integrated LED headlights (main / remote / fog lights)		■	■	■	■	■	■	■	■		
S		GRP sandwich-roof with 40 mm insulation, completely walkable. Roof outer surface GRP with tissue reinforcement and gel coat surface, white, hail suspension as far as possible. GRP-sandwich floor with 40 mm insulation.		■	■	■	■	■	■	■	■		
S		Bus exterior mirrors with long arms forward, heated, electrically adjustable, wide-angle mirror, bow observation mirror		■	■	■	■	■	■	■	■		
S		Sidewall outside width 1,8 mm GRP and 40 mm PU insulation		■	■								
S		Sidewall outside width 2,2 mm GRP and 40 mm PU insulation				■	■	■	■				
S		Sidewall outside width 3,0 mm GRP and 40 mm PU insulation								■	■		
S		Underbody construction galvanised, painted steel profiles		■	■	■	■	■	■	■	■		
S		Tempered glass hinged windows, insulating safety glass, toned. Darkening- and mosquito- blinds at the living room windows		■	■	■	■	■	■	■	■		
S		2 x roof vents with forced ventilation, darkening- and mosquito blind		■	■	■	■	■	■	■	■		
S		Honeycomb inner blind in front of the windscreen with privacy function, electrically operated (12 V)		■	■	■	■	■	■	■	■		
S		Aluminum roof rails, painted oval tube		■	■	■	■	■	■	■	■		
S		Electric entry step outside, controlled via door contact, entry steps inside		■	■	■	■	■	■				
S		Electrical double step „Double Slide Step“ on the outside, controlled by a button, entry steps on the inside				■	■	■	■	■	■		
S		Insulated and heated fresh water tank / waste water tank / holding tank		■	■	■	■	■	■	■	■		
S		Insulated double floor with raised driver's platform, even floor level		■	■	■	■	■	■	■	■		
S		Velour covering visible surfaces		■	■	■	■	■	■	■	■		
S		Exterior flaps in omnibus design, fully insulated, 2-point twist locks, gas pressure opener		■	■	■	■	■	■	■	■		
S		Insulated and heated rear garage for bicycle / scooter transport with external side hatch		■	■	■	■	■	■	■	■		
S		Fully insulated underfloor storage boxes, lined with needle felt, heated, illuminated		■	■	■	■	■	■	■	■		
S		One-key locking system for storage compartment flaps and filler neck		■	■	■	■	■	■	■	■		
S		Underbody protection treatment of the entire vehicle floor		■	■	■	■	■	■	■	■		
S	S600	Composite entrance door with 2-point locking, 2,200 x 650 mm, electric locking when the engine starts. Easy-care soft-touch interior panelling in two colors, mosquito folding door		■	■	■	■	■	■	■	■		
O	S603	Electric closing aid for entrance door		□	□	□	□	□	□	□	□	737,81	878,00
O	S608	Additional security lock mechanical entrance door	1	□	□	□	□	□	□	□	□	768,07	914,00
O	E408	Painted LED outdoor light, with integrated motion detector, permanent light switching and switch-off while driving	1	□	□	□	□	□	□	□	□	599,16	713,00
S		LED position lights, LED side marker lights, LED taillights		■	■	■	■	■	■	■	■		
O	E400	4 x LED reversing lights embedded in the side wall, switched via reverse gear	10	□	□	□	□	□	□	□	□	3.874,79	4.611,00
O	E402	Raised LED rear lights with additional turn signal/brake light	4	□	□	□	□	□	□	□	□	778,15	926,00
O	S110	Real glass window strip on the side walls, black with flush-fitting vent windows, fixed glass window in front of the entrance door, sliding window in the driver / passenger area, VARIO Perfect ≤ 950	100	□	□	□	□					19.856,30	23.629,00
O	S111	Real glass window strip on the side walls, black with flush-mounted hinged windows, fixed-glazed window in front of the entrance door, sliding window in the driver/passenger area, VARIO Perfect 1000 - 1200	130					□	□	□	□	25.152,94	29.932,00
O	M003	Automatic awning OMNISTOR 5 x 2.75 m, painted in vehicle colour, electrically operated 230 V, remote control	52	□	□							4.110,08	4.891,00
O	M004	Automatic awning OMNISTOR 6 x 2.75 m, painted in vehicle colour, electrically operated 230 V, remote control	56	□	□	□	□	□	□	□	□	4.702,52	5.596,00

Code	Description	kg	800	850	900	950	1000	1050	1100	1200	Net price EURO	Price / EURO incl. 19% German tax
BODYWORK												
○ M110	LED-Stripe under awning, 12V, 7 W/m, 4000K, dimmable, continuous light strip, no dot display, cover in vehicle colour	2	☐	☐	☐	☐	☐	☐	☐	☐	1.424,37	1.695,00
○ S302	Roof hatch with 12 V vent, forced ventilation, darkening blind	7	☐	☐	☐	☐	☐	☐	☐	☐	847,06	1.008,00
○ S303	DOMETIC winding lift sunroof Heki 3 plus, approx. 960 x 655 mm, duette honeycomb blind, forced ventilation (living room)	15	☐	☐	☐	☐	☐	☐	☐	☐	1.435,29	1.708,00
○ S305	DOMETIC winding lift sunroof midi Heki Style, approx. 700 x 500 mm, combination blind, forced ventilation	6	☐	☐	☐	☐	☐	☐	☐	☐	943,70	1.123,00
○ S500	Additional outside flap for rear end storage room with gas props (up to lower edge hinge band)	30	☐	☐	☐	☐	☐	☐	☐	☐	4.585,71	5.457,00
○ S700	Central locking system for outside storage	15	☐	☐	☐	☐	☐	☐	☐	☐	3.162,18	3.763,00
S	Rear hatch for rear garage, partial foldable rear wall and rear bumper									■		
○ S S800	Slide Out - hydraulic extendable oriel / drivers side, underframe storage rooms completely maintained, pneumatic seal system, surface heating for de-icing in winter, strengthened frame / chassis	400			☐	☐	☐	☐	■	■	48.260,50	57.430,00
○ S802	Slide Out - hydraulic extendable oriel / bed room with couch and wardrobe, pneumatic seal system, strengthened frame / chassis, surface heating system in roof and front sides	400							☐	☐	48.260,50	57.430,00
○ S803	Bed Slide Out - hydraulic extendable oriel / drivers side, underframe storage rooms completely maintained, pneumatic seal system, surface heating system in roof and front sides	300							☐	☐	39.235,29	46.690,00
○ S804	Fourth Slide Out - hydraulic extendable oriel / codriver's side (under body storage rooms completely maintained) pneumatic seal system, surface heating 12 V in the roof and face sides for defrosting snow and ice in winter	200								☐	48.260,50	57.430,00

INTERIOR												
S	Furniture construction: real wood veneer on both sides. Flaps / doors with real wood profiles, door frames with solid wood profiles		■	■	■	■	■	■	■	■		
S	Wall cupboards / living room all around and sleeping room with flaps and push-lock locking		■	■	■	■	■	■	■	■		
S	Wardrobe with clothes rail, doors with 3-point bar lock		■	■	■	■	■	■	■	■		
S	Insulated composite sliding doors with lock and automatic locking to the bathroom and bedroom		■	■	■	■	■	■	■	■		
S	SKA living room comfort seat with integrated 3-point belt, rotatable, integrated headrest and armrests, height and inclination adjustment, seat cushion depth adjustment, pneumatic lumbar support, upholstered seat		■	■	■	■	■	■	■	■		
S	ALCANTARA® / leather upholstery in the living area and in the driver's area									■		
S	Additional windscreen heating by living area heating		■	■	■	■	■	■	■	■		
S	Carpet in the living room loosely laid, removable		■	■	■	■	■	■	■	■		
S	Energy-saving LED spots embedded in the ceiling / hanging cabinets		■	■	■	■	■	■	■	■		
S F130	Interior in fine wood veneer oak - natural		■	■	■	■	■	■	■	■		
S F131	Interior in fine wood veneer beach- color subdued		■	■	■	■	■	■	■	■		
○ F132	Interior in fine wood veneer „knotty oak“ - natural		☐	☐	☐	☐	☐	☐	☐	☐	4.507,56	5.364,00
○ F133	Interior in fine wood veneer „knotty oak“ - silver, brushed		☐	☐	☐	☐	☐	☐	☐	☐	9.214,28	10.965,00
○ F134	Interior in fine wood veneer Canadian maple - light	15	☐	☐	☐	☐	☐	☐	☐	☐	4.892,44	5.822,00
○ F135	Interior in fine wood veneer Canadian maple - honey	15	☐	☐	☐	☐	☐	☐	☐	☐	4.892,44	5.822,00
○ F136	Interior in fine wood veneer American cherry tree		☐	☐	☐	☐	☐	☐	☐	☐	9.214,28	10.965,00
○ F137	Interior in fine wood veneer American walnut - light		☐	☐	☐	☐	☐	☐	☐	☐	17.398,32	20.704,00
○ F138	Interior in fine wood veneer American walnut - natural		☐	☐	☐	☐	☐	☐	☐	☐	12.899,16	15.350,00
○ F139	Interior in fine wood veneer American walnut - dark		☐	☐	☐	☐	☐	☐	☐	☐	12.899,16	15.350,00

Code	Description	kg	800	850	900	950	1000	1050	1100	1200	Net price EURO	Price / EURO incl. 19 % German tax
INTERIOR												
○ F161	Furniture construction bathroom sanding varnish white	50-100	□	□	□	□	□	□	□	□	3.382,35	4.025,00
○ F162	Furniture bedroom grinding varnish white	50-150	□	□	□	□	□	□	□	□	4.248,47	5.056,00
○ F163	Doors / flaps in white varnish	50	□	□	□	□	□	□	□	□	4.424,37	5.265,00
S F171	Furniture design „bentART“, curved flaps in precious wood veneer, cubic 30 mm side panels		■	■	■	■	■	■	■	■		
○ F008	Furniture safe with electronic combination lock	8	□	□	□	□	□	□	□	□	434,45	517,00
○ F014	Pull out system for medium high cupboard	10	□	□	□	□	□	□	□	□	1.236,13	1.471,00
○ F015	Pull out system with 3 levels for medium high cupboard with bevel front in kitchen	10						□	□	□	1.462,18	1.740,00
○ F016	2-piece pull out cabinet with 6 x baskets	20	□	□	□	□	□	□	□	□	2.352,94	2.800,00
○ F017	Additional pullout (basket)	5	□	□	□	□	□	□	□	□	256,30	305,00
○ F050	Glass show case, illuminated, mirrored rear panel, drinking glasses display, top cabinet on existent cabinet	13	□	□	□	□	□	□	□	□	2.672,27	3.180,00
○ F051	Glass show case, illuminated, mirrored rear panel, drinking glasses display	20						□	□	□	4.096,64	4.875,00
○ F052	Drinking glasses set „VARIO“ for glass show case	1	□	□	□	□	□	□	□	□	243,70	290,00
S	Living room couch substructure covered with wood, high quality upholstery		■	■	■	■	■	■	■	■		
○ F040	Extension in seating bench	8	□	□	□	□	□	□	□	□	449,58	535,00
○ F204	Living room couch, extendable, lying area 1.950 x 1.400 mm, springy wood frame, storage for bed linen in substructure	15	□	□	□	□	□	□	□	□	2.605,04	3.100,00
○ F205	Living room couch, extendable, lying area approx. 1.950 x 1.400 mm, 3-point belt for 4 th seat, removable bolster for sitting in driving direction	75	□	□	□	□	□	□	□	□	5.265,55	6.266,00
S	Bar table version with extendable interface (500 mm) and newspaper tray		■	■	■	■	■	■	■	■		
○ F030	Bar compartment, two doors in the middle under the living room table, behind them recess for bottles below, shelf above	8	□	□	□	□	□	□	□	□	515,12	613,00
○ F018	Ceiling lamps, 6 x LED spots countersunk in ceiling, dimmer	2	□	□	□	□	□	□	□	□	1.821,00	2.167,00
○ F300	Microfibre-covered panel ceiling in the living room with indirect LED lighting	90				□	□	□	□	□	16.163,02	19.234,00
○ F303	Relief structure wall, painted white wood, at exterior wall passage next to bathroom, wood element for indirect lighting, additional element on bathroom wall (glass cabinet also rear glass showcase)	85						□	□	□	7.777,31	9.255,00
○ F311	Hanging bar table, extendable, without fixed table base, stabilizing foldable table base when pulled out	20				□	□	□	□	□	2.333,61	2.777,00
○ F400	Interior “blackLine“ (fittings, handles, taps black)		□	□	□	□	□	□	□	□	3.670,59	4.368,00
S	Rear bed ventilated, with FROLI bed system, formfit cold foam mattress, 1.500 x 2.000 mm		■									
S	Rear bed ventilated, with FROLI bed system, formfit cold foam mattress, 1.600 / 1.700 x 2.000 mm			■	■	■	■	■	■	■		
○ F020	Adjustable head board for rear bed / single bed	6	□	□	□	□	□	□	□	□	315,12	375,00
○ F003	Fold away bed (1.950 x 1.300 mm) above drivers seats, instead of hanging cupboards	60	□	□	□	□	□	□	□	□	5.452,10	6.488,00
○ N003	Air suspended driver- / passenger- seat including air switch off valve	30	□	□	□	□	□	□	□	□	2.986,55	3.554,00
○ N006	Leather upholstery living area	20	□	□	□	□	□	□	□	□	5.584,03	6.645,00
○ N012	ALCANTARA [®] upholstery	10	□	□	□	□	□	□	□	□	4.726,89	5.625,00
○ N030	Granite entry stairs sideways / ceramics / porcelain stoneware	20				□	□	□	□	□	731,09	870,00
○ N031	Granite / ceramics / porcelain flooring in the passageway adjacent bathroom with 2 steps	60						□	□	□	2.321,01	2.762,00
○ N018	Wooden blinds living room / kitchen / bedroom / bath	20	□	□	□	□	□	□	□	□	3.060,50	3.642,00
○ N038	GFW darkening honeycomb blind with privacy function on drivers and co-drivers window, absolutely opaque	8	□	□	□	□	□	□	□	□	1.540,34	1.833,00

Code	Description	kg	800	850	900	950	1000	1050	1100	1200	Net price EURO	Price / EURO incl. 19 % German tax
KITCHEN												
S	Rubbish bin with cover, flush integrated in counter top		■	■	■	■	■	■	■	■		
S	Bar tray made of solid wood as splash guard function between kitchen and lounge		■	■	■	■	■	■	■	■		
S	Hanging cupboards with flaps, shelves and push-lock-mechanism		■	■	■	■	■	■	■	■		
S	Drawers and pull outs on roller bearing		■	■	■	■	■	■	■	■		
S	Outlets 2 x 230 V		■	■	■	■	■	■	■	■		
S F004	Kitchen counter top CORIAN® / STARON®		■	■	■	■	■	■	■	■		
O F024	Kitchen rear panel CORIAN® / STARON®	10	□	□	□	□	□	□	□	□	980,67	1.167,00
S P000	3-flames high grade steel gas cooker with integrated glass cover, automatic ignition, countersunk in counter top		■	■	■	■	■	■	■	■		
O P001	Induction cooktop, 2 burners, 230 V, touch screen	10		□	□	□	□	□	■	■	1.018,49	1.212,00
S	High grade steel sink countersunk in counter top, with cover		■	■	■	■	■	■	■	■		
O P016	STARON sink, angular, flush	5	□	□	□	□	□	□	□	□	529,41	630,00
O P013	FRANKE sink with drip of bowl and CORIAN® / STARON®-cover, eccentric close system	6	□	□	□	□	□	□	□	□	703,36	837,00
S	Single hand control tap, chrome		■	■	■	■	■	■	■	■		
O W001	Single hand control tap with removable sprinkler	2	□	□	□	□	□	□	□	□	339,50	404,00
S K004	177 l refrigerator with AES, 35 l ice box		■	■	■	■						
S K009	177 l refrigerator with AES, 35 l ice box, mounted behind trailing door						■	■				
O K008	195 l Compressor refrigerator Kissmann KT210, 151 liter refrigerator, 44-liter freezer, 12 V with integrated 230 V priority circuit. Optional - instead of 177 l refrigerator			□	□	□	□	□	■	■	0,00	0,00
O F043	„cubeART“ kitchen unit, side panels and worktop as a 45 mm all-round frame, handle niche including indirect LED lighting, design kitchen fitting	22					□	□	□	□	5.030,25	5.986,00
O P007	Dish washer EXQUISIT, fully integrated	30		□	□	□	□	□	□	□	1.896,64	2.257,00
O P014	Dish washer Fisher / Paykel, Toploader, fully integrated	38		□	□	□	□	□	□	□	2.847,90	3.389,00
O P004	Microwave with integrated grill	17	□	□	□	□					1.410,08	1.678,00
O P998	MIELE Microwave / hot air oven, 2.200 W	30			□	□	□	□	□	□	3.690,76	4.392,00
O P010	Preparation for Espresso automat niched in furniture, extension, turn around system, 230 V outlet	5		□	□	□	□	□	□	□	956,30	1.138,00
O P011	Espresso automat JURA 230 V	9		□	□	□	□	□	□	□	1.478,15	1.759,00
O P006	Washing machine/dryer, washer 8 kg, dryer 4 kg, 230 V / 10 A in outside storage room	88					□	□	□	□	4.200,84	4.999,00
O P009	Washing machine CANDY HOOVER, 3,5 kg, 230 V	55	□	□	□	□	□				3.094,12	3.682,00
S	Design flooring kitchen, very resistant object floor		■	■	■	■	■	■	■	■		
O F042	Granite / ceramics / porcelain flooring kitchen	100			□	□	□	□	□	□	5.026,05	5.981,00
BATH												
S	Inside area splash water-repellent, washable coated		■	■	■	■	■	■	■	■		
S	Washstand - floor cupboard with doors		■	■	■	■	■	■	■	■		
S	Mirrored cabinet, threepart mirror, shelves		■	■	■	■	■	■	■	■		
S	Separate shower with folding / sliding door, single hand control shower tap with water saving sprinkler, chrome		■	■	■	■	■	■	■	■		
S	Lots of bathroom accessories (soap dispenser, toothbrush mug, toilet paper holder, towel hook), 230 V socket		■	■	■	■	■	■	■	■		
S	Additional tray with chrome railing in shower CORIAN® / STARON®		■	■	■	■	■	■	■	■		

	Code	Description	kg	800	850	900	950	1000	1050	1100	1200	Net price EURO	Price / EURO incl. 19 % German tax
S	J001	Wash stand top mineral material STARON® pure white with countersunk washbasin pure white		■	■	■	■	■	■	■	■		
○	J002	CORIAN® / STARON® rear panel wash stand / toilet	10	□	□	□	□	□	□	□	□	1.809,24	2.153,00
○	J003	CORIAN® / STARON® rear panel in shower, console for mixing tap CORIAN® / STARON®	20	□	□	□	□	□	□	□	□	3.245,38	3.862,00
○	J006	CORIAN® / STARON® bowl custom colours / special form	5	□	□	□	□	□	□	□	□	516,81	615,00
○	J044	„rustART“ design panel, three-hole mixing tap, indirect LED lighting	3	□	□	□	□	□	□	□	□	1.731,09	2.060,00
○	J050	„concreteART“ design panel, design mixing tap, indirect LED lighting	3	□	□	□	□	□	□	□	□	1.800,00	2.142,00
○	J020	Wash stand plate granite	30	□	□	□	□	□	□	□	□	2.724,37	3.242,00
○	J022	Granite-light weight wall covering/shower, granite console for tap, rear panel construction, wash stand granite	60					□	□	□	□	9.394,12	11.179,00
○	J032	Thermostatic mixing shower tap, chrome	1	□	□	□	□	□	□	□	□	295,80	352,00
○S	J040	Real glass quarter circle shower, together with bath version “extra roomy”	15	□	□	□	■	■	■	■	■	2.574,79	3.064,00
○	J009	CORIAN® / STARON® quarter circle shower basin	25	□	□	□						5.138,66	6.115,00
○	J004	CORIAN® / STARON® quarter circle shower basin	10				□	□	□	□	□	2.462,18	2.930,00
○	J008	CORIAN® / STARON® 5-corner shower embedded into the floor, concealed drain, real glass shower door	30						□	□	□	7.754,62	9.228,00
S		Fixed ceramic water flush toilet SEALAND		■	■	■	■	■	■	■	■		
○	J045	TECMA E-Breeze macerator toilet with bidet function	15	□	□	□	□	□	□	□	□	2.718,49	3.235,00
S		Flooring in the bathroom: design flooring / highly durable object floor		■	■	■	■	■	■	■	■		
○	J021	Granite / ceramics / porcelain stoneware flooring	100			□	□	□	□	□	□	4.977,31	5.923,00
○	J060	Bathroom walls in concrete look	30	□	□	□	□	□	□	□	□	4.125,21	4.909,00
MULTIMEDIA													
○	E000	QLED-flat screen TV 43“, 230 V, remote control	35				□	□	□	□	□	4.197,48	4.995,00
○	E012	LED flat screen TV 40“, 12V, remote control, with external control module (sound system required)	15			□	□	□	□	□	□	4.197,48	4.995,00
○	E099	Electric lift, 12 V / TV 32“ / 40“	15				□	□	□	□	□	1.044,54	1.243,00
○	E001	QLED-flat screen TV 32“, 230 V, remote control	30	□	□	□	□	□	□	□	□	3.725,21	4.433,00
○	E002	LED flat screen TV 32“, 12 V, remote control	20	□	□	□	□	□	□	□	□	3.055,46	3.636,00
○	E004	Satellite system CRYSTOP Autosat 2, 85 cm parabolic reflector, autolevel, control panel	30	□	□	□	□	□	□	□	□	4.671,43	5.559,00
○	E006	Option „SKEW“ Internet / TV for Autosat, together with E004		□	□	□	□	□	□	□	□	566,39	674,00
○	E011	Apple TV 4 K (64 GB)		□	□	□	□	□	□	□	□	889,92	1.059,00
○	E007	BlueRay-Player	3	□	□	□	□	□	□	□	□	659,66	785,00
○	E055	PIONEER DAB+ radio system with CD, UKW, MW, 4 x 50 W, 4 x loudspeakers, roof antenna, Bluetooth hands-free system, iPod / iPhone interface (bedroom)	4	□	□	□	□	□	□	□	□	1.788,23	2.128,00
○	E104	Audio connection Radio system with LED flat screen	1	□	□	□	□	□	□	□	□	410,08	488,00
○	E117	Sound system with active subwoofer (4 x speakers + subwoofer)	10	□	□	□	□	□	□	□	□	1.356,30	1.614,00
○	E118	JEHNERT sound system with additional amplifier, 4 x 2-way speaker system embedded flush in the furniture, bass reflex subwoofer, additional Bluetooth interface for music streaming via smartphone	5	□	□	□	□	□	□	□	□	4.092,44	4.870,00
○	E853	5G Router, 12 V, DUAL SIM-Slot, (5G / LTE / 3G), WIFI / GPS roof antenna	2	□	□	□	□	□	□	□	□	1.907,56	2.270,00

Code	Description	kg	800	850	900	950	1000	1050	1100	1200	Net price EURO	Price / EURO incl. 19 % German tax
ELECTRICS												
S	230 V external connection with feed cable, FI personal protection device		■	■	■	■	■	■	■	■		
S	Battery monitor / ampere-hour meter for living area batteries		■	■	■	■	■	■	■	■		
S	Automatic charging of the living area batteries while driving 14 V / 37 A		■	■	■	■	■	■	■	■		
S	Automatic shutdown of the on-board power supply in the event of battery undervoltage		■	■	■	■	■	■	■	■		
S	LCD VARIO control panel for monitoring the fresh water, waste water, toilet tank and battery voltage of the vehicle and living area battery		■	■	■	■	■	■	■	■		
S	VARIO relay distributor with 230 V and 12 V fuse, gas / generator tank display, automatic switching from external and generator power		■	■	■	■	■	■	■	■		
S	Electrical lines laid in cable ducts for easy servicing, central electrical unit with control cabinet technology terminals		■	■	■	■	■	■	■	■		
S	Lighting with energy-saving LED spots, separate circuit		■	■	■	■	■	■	■	■		
S	Central main battery switch in the panel for all for all extraction points		■	■	■	■	■	■	■	■		
S	Mechanical main battery switch for starter batteries		■	■	■	■	■	■	■	■		
S	E605 Mechanical main battery switch for living area batteries		■	■	■	■	■	■	■	■		
S	Maintenance-free living area gel battery EXIDE Solar 1 x 12 V / 170 Ah, automatic battery charger 12 V / 35 A, microprocessor controlled with soft start and battery temperature sensor		■	■	■	■	■	■	■	■		
S O	E200 Maintenance-free living area gel batteries EXIDE Solar 2 x 12 V / 170 Ah (340 Ah), automatic battery charger 12 V / 50 A, microprocessor-controlled with soft start and battery temperature sensor	70	□	□	□	□	□	□	□	■	1.524,37	1.814,00
O	E242 CTEK automatic charger 24 V / 4 A for starter batteries	2	□	□	□	□	□	□	□	□	655,46	780,00
O	E241 CTEK automatic charger 24 V / 14 A for starter batteries	4			□	□	□	□	□	□	814,28	969,00
O	E100 VARIO-CANBUS control with 7" touch monitor including smartphone control via WLAN in the vehicle, heating control, tank level display, battery capacity monitoring, inverter control, solar power display (only together with LTE / WLAN router, code E853)	5	□	□	□	□	□	□	□	□	4.749,58	5.652,00
O	E403 Floor lighting 4 x in the floor area, changeover switch	2	□	□	□	□	□	□	□	□	738,65	879,00
O	E651 ETA lighting bus control, light control modules, light circuits dimmable, programmable	6	□	□	□	□	□	□	□	□	5.410,08	6.438,00
O	E701 Indirect LED lighting kitchen worktop	1	□	□	□	□	□	□	□	□	384,03	457,00
O	E702 Indirect LED lighting vanity top and mirror cabinet	1	□	□	□	□	□	□	□	□	494,96	589,00
O	E703 Indirect LED lighting for head end of rear bed together with wooden panel and rear bed frame. Can be switched individually.	4	□	□	□	□	□	□	□	□	757,98	902,00
O	E704 Indirect LED lighting living room wall cupboards < 950	10	□	□	□						2.016,81	2.400,00
O	E705 Indirect LED lighting living room wall cupboards	20				□	□	□	□	□	3.432,77	4.085,00
O	E706 LED reading lamp with gooseneck	1	□	□	□	□	□	□	□	□	231,09	275,00
S	Several outlets, 12 / 230 V		■	■	■	■	■	■	■	■		
O	E600 Outlet 230 V additional	1	□	□	□	□	□	□	□	□	173,11	206,00
O	E601 Outlet 12 V additional	1	□	□	□	□	□	□	□	□	173,11	206,00
O	E602 Double outlet 230 V in garage for e-bikes	1	□	□	□	□	□	□	□	□	173,11	206,00
O	E603 Outlet 24 V, switched over ignition, front windshield / toll device	1	□	□	□	□	□	□	□	□	196,64	234,00
O	E606 USB-C/A Power-double socket 5 V / 3,6 A	1	□	□	□	□	□	□	□	□	226,89	270,00
O	E609 Wireless Smartphone Charger, inductive charging of a smartphone, integrated invisibly in the furniture	1	□	□	□	□	□	□	□	□	365,55	435,00

Code	Description	kg	800	850	900	950	1000	1050	1100	1200	Net price EURO	Price / EURO incl. 19 % German tax
○ E270	VICTRON Multi Plus 3000 charger / sine - inverter - combination, charging capacity 12 V / max. 120 A, external power connection adjustable from 4 - 16 A, sine wave inverter with 12 - 230 V / 3,000 VA, Touch GX 50 panel, including 2 x gel batteries 12 V / 170 Ah (total capacity 12 V / 340 Ah)	80	□	□	□						7.108,40	8.459,00
○ E272	VICTRON Multi Plus 3000 charger / sine wave inverter combination, charging capacity 12 V / max. 120 A, external power connection adjustable from 4 - 16 A, sine wave inverter with 12 - 230 V / 3,000 VA, Touch GX 50 panel, including 2 x lithium -Battery LiPo 12.8 / 200 Ah tempered (total capacity 400 Ah)	30	□	□	□	□	□	□			12.401,68	14.758,00
○ E273	VICTRON Multi Plus 3000 charger / sine wave inverter combination, charging capacity 12 V / max. 120 A, external power connection adjustable from 4 - 16 A, sine wave inverter with 12 - 230 V / 3,000 VA, Touch GX 50 panel, including 2 x lithium -Battery LiPo 12.8 / 300 Ah tempered (total capacity 600 Ah)	40	□	□	□	□	□	□			14.794,11	17.605,00
○ E275	VICTRON Quattro 5000 charger / sine wave inverter - combination, charging capacity 12 V / max. 220 A, external power connection adjustable from 4 - 16 A, sine wave inverter with 12 - 230 V / 5,000 VA, Touch GX 50 panel, including 3 x lithium batteries LiPo 12.8 V / 300 Ah, tempered (total capacity 900 Ah)	150			□	□	□	□	□	□	20.970,59	24.955,00
○ E277	VICTRON Quattro 5000 charger / sine wave inverter - combination, charging capacity 12 V / max. 220 A, External power connection adjustable from 4 - 16 A, sine wave inverter with 12 - 230 V / 5000 VA, Touch GX 50 panel, including 4 x lithium batteries LiPo 12.8 V / 300 Ah, tempered (total capacity 1,200 Ah)	180							□	□	24.463,87	29.112,00
○ E278	VICTRON Quattro 5000 charger / sine inverter combination, loading capacity 12 V / max. 220 A, external power connection adjustable 4 – 16 A , sinus inverter with 12 – 230 VA / 5000 VA, GX 50 touch panel, 6 x lithium battery LiPo 12,8 V / 300 Ah, tempered (total capacity 1800 Ah)	260							□	□	31.428,57	37.400,00
○ E311	Charging current increase while driving up to 24 -> 14 V / 70 A, with 24 V chassis	2	□	□	□	□	□	□	□	□	768,91	915,00
○ E312	Charging current increase while driving up to 24 -> 14 V / 140 A, with 24 V chassis (MB Actros)	3			□	□	□	□	□	□	1.793,28	2.134,00
○ E313	Second power supply with FI circuit breaker 230 V / 16 A with switch circuit 1-2, CEE connection cable	5					□	□	□	□	2.781,51	3.310,00
SOLAR												
○ E233	Solar panels 380 W (total capacity), charge controller	35		□	□	□	□	□	□		3.653,78	4.348,00
○ E234	Solar panels 570 W (total capacity), charge controller	55		□	□	□	□	□	□	□	5.725,21	6.813,00
○ E235	Solar panels 760 W (total capacity), charge controller	75			□	□	□	□	□	□	7.535,29	8.967,00
○ E237	Solar panels 1.140 W (total capacity), charge controller	110					□	□	□	□	11.792,44	14.033,00
○ E239	Solar panels 1.520 W (total capacity), charge controller	140					□	□	□		14.130,25	16.815,00
○ E240	Solar panels 1.710 W (total capacity), charge controller	155					□	□	□		15.300,00	18.207,00
GENERATOR												
○ G003	Fuel generator DOMETIC TEC 29, 2,6 kW (25°C), 230 V, 1 x cylinder, noise absorber box, operating panel, 30 l tank, fuel gauge	85	□	□	□						9.868,91	11.744,00
○ G009	ONAN diesel generator, 4.8 kW (29°C), STAGE V, 230 V, 2,880 rpm, 2 x cylinder KUBOTA diesel engine, water-cooled, in soundproof box with integrated cooler/fan unit and exhaust system, control panel, generator in insulated external storage space assembled.	220			□	□	□	□	□	□	19.207,56	22.857,00
○ G020	Fuel cell EFOY pro 2800, 12 V / 125 W inclusive 10 l methanol fuel cartridge	22	□	□	□	□	□	□	□	□		request

Code	Description	kg	800	850	900	950	1000	1050	1100	1200	Net price EURO	Price / EURO incl. 19 % German tax
AIR CONDITION												
○ E902	Roof air conditioner DOMETIC FreshJet 3500, 230 V, cooling capacity 3,500 W, remote control	40	☐	☐	☐	☐					4.324,37	5.146,00
○ E906	SPLIT air conditioning VARIO Cool, 230 V, cooling capacity approx. 1,900 W, evaporator integrated in furniture construction, compressor / underfloor condenser unit in stainless steel housing, remote control (bedroom)	75			☐	☐	☐	☐	☐	☐	11.772,27	14.009,00
○ E907	SPLIT VARIO Cool Twin air conditioner, 230 V, cooling capacity approx. 3,600 W, evaporator integrated in furniture construction, twin compressor/condenser unit installed underfloor in stainless steel housing, remote control (living room)	100			☐	☐	☐	☐	☐	☐	20.541,18	24.444,00
○ E908	Second evaporator for cooling the bedroom, remote control, second control with solenoid valves - only together with E 907 (Evaporators operated individually or together, whereby the power is shared - temperate climate zones)	20			☐	☐	☐				6.354,62	7.562,00
○ E910	Air conditioning duct in the front wall cabinet with air vent in the middle only together with E907	10			☐	☐	☐	☐	☐	☐	529,41	630,00
○ E911	Suspended ceiling as a panel ceiling with microfibre covering and indirect LED lighting, integrated oval dome with indirect LED lighting and suspended Satinato acrylic glass panel, air vents for air conditioning, air conditioning ducts integrated in the suspended ceiling, 8 LED spots embedded in the ceiling (only together with E307)	100						☐	☐	☐	21.166,39	25.188,00

SCOOTER GARAGE / PASSENGER CAR GARAGE												
○ R201	THULE VELO slide, E-bike rack for 2 bicycles, extendable	23	☐	☐	☐	☐	☐	☐	☐	☐	1.202,52	1.431,00
○ R204	Installation scooter, included rack and ramp	20	☐	☐	☐	☐	☐	☐	☐	☐	1.889,92	2.249,00
○ X101	Rear flap for rear end garage, partial movable rear panel and rear bumper	150					☐	☐	☐	■	15.610,92	18.577,00
○ X102	Electrically operated sliding platform for small cars with automatic centering of the car on the platform, load capacity up to 1,000 kg (SMART)	250					☐	☐	☐	☐	22.978,99	27.345,00
○ X103	Electric sliding platform for automatic car retraction, load capacity approx. 1,300 kg (Mini, Fiat 500, Abarth 595, Toyota Aigo, VW up)	400						☐	☐	☐	29.820,17	35.486,00
○ X104	Hydraulic sliding platform for automatic car retraction, load capacity approx. 1,700 kg (Porsche, Mercedes-Benz)	580								☐	45.673,95	54.352,00
○ X105	Tailgate / car garage hydraulic operating and remote control, hiding inside hinges	70					☐	☐	☐	☐	14.144,54	16.832,00
○ X110	Mobile charging station for e-cars in the car garage, type 2 connection, 1,4 – 22 kW adjustable, 230 V socket (various connection plugs)	5					☐	☐	☐	☐	1.773,11	2.110,00

GAS												
S	Gas bottle box for 2 x 11 kg bottles, TRUMA DuoControl safety regulator with Duo C remote display and ice-ex		■	■	■	■	■	■	■	■		
S	Extension for 2 x 11 kg gas bottles (easy operating system)		■	■	■	■	■	■	■	■		
○ S	B003 Gas tank 110 l ice-ex (80 % fillable), safety regulator, remote display, remote filling	100	☐	☐	☐	☐	■	■	■		4.928,57	5.865,00
○	B005 Gas extraction valve under outside storage compartment	2	☐	☐	☐	☐	☐	☐	☐	☐	364,71	434,00
○	B006 Gas remote switch for gas bottle system	1	☐	☐	☐	☐	☐	☐	☐	☐	315,13	375,00
○	Z007 2 x bottles grey per 11 kg, filled	48	☐	☐	☐	☐	☐	☐	☐	☐	268,91	320,00
S	B011 Motorhome without gas system (no 116 l gas tank / gas cylinder box), therefore 160 l diesel tank in the heated underfloor storage space, emergency switching to vehicle diesel tank with 3-way valve (only together with H200 / H 201)							☐	☐	■	0,00	0,00

	Code	Description	kg	800	850	900	950	1000	1050	1100	1200	Net price EURO	Price / EURO incl. 19 % German tax
HEATING													
S	H000	„ALDE Compact 3030“ hot water gas central heating with wall convectors, additional windscreen heating and exterior storage space heating as well as integrated hot water boiler 10 l, heating output propane 5,500 W / butane 6,400 W, electric heating cartridge 230 V - 1,050 / 2,100 W, thermostatic control, engine heat exchanger		■	■	■	■	■	■				
S/O	H200	Hot water diesel heater SCHEER MH 10/17 blue efficiency Two-stage Blue efficiency, heating output 10,000 W / 17,000 W, low-temperature diesel heater with blue burner technology and automatic altitude correction adjustment up to an altitude of 3,000 m, combustion at approx. 1,450° C for maximum reduction of exhaust gases, 100% soot-free, efficiency approx. 93%, integrated plate heat exchanger for hot water preparation, 3-room control with separate room thermostats, wall convectors in all rooms, controlled underfloor heating in the living room / kitchen and bathroom, heating of the insulated underfloor storage rooms (except for the car garage), heating of the windscreen via convectors, electric heating element 230 V/1,000 -2,000 W, engine heat exchanger for heating while driving, separate 160 l diesel tank in heated underfloor storage compartment, fuel filler flap, emergency switchover to vehicle tank (2-way valve), no gas system	140					□	□	■	■	30.257,98	36.007,00
O	H300	Hot water diesel heater SCHEER MH 10 Micro Blue burner efficiency, heating capacity 10.000 W, low temperature diesel heater with blue burner technology and automatic height adjustment to 3.000 m, burning at approx. 1.450° C for maximum reduction of exhaust gases, 100 % soot-free, efficiency approx. 90 %, integrated hot water preparation via plate heat exchanger, Hot water priority switching, wall convectors in all rooms, electric heating cartridge 230 V / 1.000 – 2.000 W, engine heat exchanger for heating while driving, inverter 12 – 230 V / 500 W, elimination of gas system, fuel extraction from the chassis diesel tank, emergency shutdown when the diesel tank is too low, necessary: compressor refrigerator and induction cooker, enlarged solar system, lithium batteries, recommended: larger diesel tank	0			□	□	□	□			6.389,92	7.604,00
S		Engine heat exchanger for heating the living area with waste heat from the engine		■	■	■	■	■	■	■	■		
S		Night time heating reduction can be set for a limited time		■	■	■	■	■	■	■	■		
O	H002	Underfloor heating in the living room with thermostatic control, under the bar table / footwell area of the driver's / passenger's seat	25	□	□	□	□	□	□	□	■	2.620,17	3.118,00
O	H004	Underfloor heating in the bathroom area	6	□	□	□	□	□	□	■	■	1.628,57	1.938,00
O	H006	Bedroom heating with separate room thermostat, controllable	6	□	□	□						947,90	1.128,00
O	H007	ALDE Flow, 6 l hot water boiler in addition to the ALDE boiler in the system, integrated (temporary hot water priority)	12	□	□	□	□	□				2.718,49	3.235,00
O	H008	WEBASTO Thermo Top hot-water diesel heater in the ALDE heating circuit, additional heat output 5,000 W, thermostatic control (for winter operation)	10	□	□	□	□	□				5.839,50	6.949,00
O	H009	WEBASTO Thermo Pro 90 hot water diesel heater integrated in the hot water heating circuit, heat output 9,000 / 7,200 W, modulating burner, thermostatic control (for winter operation)	15						□	□	□	6.670,59	7.938,00
O	H011	Bathroom heating with room thermostat, individual room control	15				□	□	□	■	■	2.725,21	3.243,00
O	H012	Bedroom heating with room thermostat, individual room control	15				□	□	□	■	■	2.725,21	3.243,00
O	H016	Towel dryer bathroom white, temperature controller	10	□	□	□	□	□	□	□	□	668,07	795,00
O	H017	Towel dryer bathroom chrome, temperature controller	10	□	□	□	□	□	□	□	□	920,17	1.095,00

Code	Description	kg	800	850	900	950	1000	1050	1100	1200	Net price EURO	Price / EURO incl. 19 % German tax
WATER SUPPLY												
S	Fresh water tank in the insulated and heated double floor, quick drain valve		■	■	■	■	■	■	■	■		
S	Fresh water tank, capacity 300 l		■									
S	Fresh water tank, capacity 350 l			■								
S	Fresh water tank, capacity 400 l				■	■	■					
S	Fresh water tank, capacity 450 l							■				
S	Fresh water tank, capacity 500 l								■	■		
S	Grey water tank in the insulated and heated double floor, drain slide in the heated interior		■	■	■	■	■	■	■	■		
S	Grey water tank, capacity 200 l		■									
S	Grey water tank, capacity 250 l			■	▣	■						
S	Grey water tank, capacity 300 l				▣		■	▣				
S	Grey water tank, volume 350 l							▣	■			
S	Grey water tank, capacity 400 l									■		
S	Toilet tank in the insulated and heated double floor, emptying slide in the heated interior		■	■	■	■	■	■	■	■		
S	Toilet tank, capacity 200 l		■	■								
S	Toilet tank, capacity 250 l				■	■	■	▣				
S	Toilet tank, capacity 300 l							▣	■	■		
S	Water system with powerful pressure water pump 11 l / min and expansion tank		■	■	■	■	■	■	■	■		
S	Quick drain valves / entire water system (winter drain)		■	■	■	■	■	■	■	■		
S	Central disposal outlet with 3" bayonet connection for waste water/toilet tank		■	■	■	■	■	■	■	■		
S	Disposal hose, extendable, housed in a separate container		■	■	■	■	■	■	■	■		
S	Fresh water tank filling with GARDENA® - connection in storage compartment		■	■	■	■	■	■	■	■		
O	W002 Outside shower with mixer tap (cold / warm) in outside storage compartment	5	▣	▣	▣	▣	▣	▣	▣	▣	662,18	788,00
O	W104 City water connection with pressure reducer	2	▣	▣	▣	▣	▣	▣	▣	▣	854,62	1.017,00
O	W105 Water pump reinforced 19 l / min	2					▣	▣	▣	▣	472,27	562,00
O	W201 drinking water treatment plant	4	▣	▣	▣	▣	▣	▣	▣	▣	511,76	609,00
O	W202 SEAGULL - drinking water treatment plant	6	▣	▣	▣	▣	▣	▣	▣	▣	1.675,63	1.994,00
O	W400 Toilet tank flushing (connection between waste water / toilet tank with slider)	3	▣	▣	▣	▣	▣	▣	▣	▣	696,64	829,00
O	W401 Additional waste water hose 3" / 3 m with bayonet connection, container	6	▣	▣	▣	▣	▣	▣	▣	▣	256,30	305,00
O	W402 12 V macerator pump with bayonet connection, 12 V socket	10	▣	▣	▣	▣	▣	▣	▣	▣	2.449,58	2.915,00
O	W403 Collapsible hose set with bayonet connection 20 + 20 + 10 m, white, in transport box for macerator pump	10	▣	▣	▣	▣	▣	▣	▣	▣	517,65	616,00

Code	Description	kg	800	850	900	950	1000	1050	1100	1200	Net price EURO	Price / EURO incl. 19 % German tax
EXTERIOR DESIGN / PAINTWORK / EXTERIOR WALLS												
S	High-quality painting of the entire vehicle in 2-components - car paint uni white, roof gelcoat surface white		■	■	■	■	■	■	■	■		
S	Elegant color stripe design		■	■	■	■	■	■	■	■		
O	L013 Painting plain coloured special „VM Chalk 01“	0	□	□	□	□	□	□	□	□	6.476,47	7.707,00
O	L014 Exterieur „BlackLINE“, black rims (6)	0	□	□	□	□	□	□	□	□	4.500,00	5.355,00
O	L015 Exterieur „BlackLINE“, black rims (8)	0								□	4.900,00	5.831,00
O	L016 Exterieur „BlackLINE“, black painted exhaust tips, licence plate panel, light surrounds	0	□	□	□	□	□	□	□	□	600,00	714,00
O	L102 Metallic paintwork, two-layer paintwork with clear coat, VARIO Perfect 800 - 950	50	□	□	□	□					8.728,57	10.387,00
O	L103 Metallic paintwork, two-layer paintwork with clear coat, VARIO Perfect 1000 - 1200	60					□	□	□	□	10.784,03	12.833,00
O	L106 Exclusive design finish		□	□	□	□	□	□	□	□	request	

MISCELLANEOUS												
S	Individual construction, compilation / sampling of the interior and the exterior design according to customer requirements		■	■	■	■	■	■	■	■		
S	100% custom build. Every VARIOmobil is an exquisite one-off.		■	■	■	■	■	■	■	■		
O	Y000 Reduced to weight variant 7,490 kg in connection with fresh water tank valve „driving position“, 100 l fresh water tank (Deduct weight of fresh water tank filling > 100 l)	-100 bis -250	□	□							805,04	958,00
O	Y001 TÜV inspection, EU certificate		□	□	□	□	□	□	□	□	945,38	1.125,00
O	Z001 Ultrasonic alarm system with door / storage compartment contacts, living room interior surveillance can be deactivated, remote control	4	□	□	□	□	□	□	□	□	2.255,46	2.684,00
O	Z002 Code lock for front door / alarm system	1	□	□	□	□	□	□	□	□	947,90	1.128,00
O	Z003 Service package, 2 x 20 m GARDENA folding hose, Euro gas tank adapter, Euro gas bottle adapter	6	□	□	□	□	□	□	□	□	503,36	599,00
O	Z004 "K.O." - Gas warning device in the bedroom	1	□	□	□	□	□	□	□	□	431,09	513,00
O	Z014 Fire extinguisher 2 kg	3	□	□	□	□	□	□	□	□	232,77	277,00

Code	Description	kg	800	850	900	950	1000	1050	1100	1200	Net price EURO	Price / EURO incl. 19 % German tax

EQUIPMENT PACKAGE VARIO Perfect 1200 PLATINUM

○ Q003

Bedroom

- Furniture satin white
- Design LED light panel above the rear bed
- 6 LED spots embedded in the ceiling, dimmable
- Microfibre wall paneling in the Slide Out, concealed roller blind guide
- 2 x LED wall lamp, CUBE up and down, bedside table right. / left
- Indirect LED corridor lighting, bed footboard
- Wireless smartphone charger, inductive charging, integrated invisibly in the furniture, bedside table on the right. / left
- Leather upholstery for bedroom couch

Bath

- Furniture satin white, vanity unit with handle niche including indirect LED lighting
- CORIAN® / STARON® vanity top with wood interlayer
- CORIAN® / STARON® handle strips on mirror cabinet doors
- Dirty linen cupboard with basket and removable laundry bag
- CORIAN® / STARON® countertop washbasin, concealed drain with RGB LED lighting
- „rustART“ panel with platinum three-hole washbasin fitting, indirect LED lighting
- CORIAN® / STARON® corner shower tray embedded flush in the floor, concealed dual drain
- Real glass corner shower partition 1-leaf door with automatic lifting mechanism „fineLINE“ LED lighting Shower ceiling
- Thermostatic mixer tap, Platinum

Kitchen

- Wooden kitchen splashback, dark American walnut
- Refrigerator integrated in furniture construction behind sliding door
- „cubeART“ kitchen unit, side panels and worktop as a 45 mm all-round frame, recessed grip incl. indirect LED lighting
- CORIAN® / STARON® countertop
- Single-lever mixer tap, Platinum

Living room

- Suspended ceiling as panel ceiling with microfibre covering and indirect LED lighting, integrated oval dome with indirect LED lighting and suspended design RGBW LED light panel, dimmable, air vent for air conditioning, air conditioning duct integrated in the suspended ceiling, 8 x LED spots embedded in the ceiling
- rounded furniture wall, integrated glass display cabinet with lighting, rear wall relief, plexiglass holder for glasses
- relief structured furniture walls white in the area of the glass showcase/back wall of the glass showcase „fineLINE“ LED lighting and passageway rea to the bedroom with walnut design bar, retractable coat hooks, indirect RGBW LED lighting
- Table top CORIAN® / STARON® with walnut edging, dinette
- Table top walnut, living room
- Wireless smartphone charger, inductive charging of a smartphone, integrated invisibly in the furniture, living room table
- BOSE loudspeakers integrated in the wall cupboard flap at the front
- Micro up / down spot on slide-out furniture panel right / left
- LED step lighting

Code	Description	kg	800	850	900	950	1000	1050	1100	1200	Net price EURO	Price / EURO incl. 19 % German tax
	<p>Miscellaneous</p> <ul style="list-style-type: none"> --- Dashboard bi-color, black / brasil --- Microprocessor-controlled Platinum lighting system in total. Vehicle: Illuminated sensor control panel, memory light scenes, coming / leaving home, various dimming functions --- Pleated blackout mosquito blind, aluminum handle / profiles plastic-coated, Mesh fabric with dirt-repellent nano coating, living room, kitchen, bathroom, bedroom --- Pleated blackout curtains driver's cab left / right, --- Decorative curtains driver's cab left / right --- Wooden blinds in the living room, kitchen, bathroom, bedroom --- LINEA LED lighting, rear garage --- Platinum design finish pearl silver <p>Equipment package Platinum</p>	365							☐	☐	144.894,96	172.425,00

HIGH END MOTORHOMES. INDIVIDUAL BUSINESS VEHICLES. CUSTOM MADE IN GERMANY. BE MOBILE WORLDWIDE.



An Teckners Tannen 1
49163 BOHMTE / GERMANY

Phone ++49 5471 - 95 11 - 0
Service ++49 5471 - 95 11 - 40
Fax ++49 5471 - 95 11 - 59
M@il info@vario-mobil.com
Welcome! www.vario-mobil.com



VARIOmobil does not represent or warrant that its motorhomes can lawfully be operated on all roads or in all states. Laws restricting the length, width, and/or weight of vehicles vary from state to state. It is the responsibility of each prospective purchaser of a motorhome to determine any limitations or restrictions on the use of the motorhome in the states in which the purchaser intends to use it. Due to constant product improvement, styling, design, equipment and construction are subject to change without notice or obligation. We reserve the right to make changes, but are happy to verify any item on request. Some items featured may be optional.

08 | 2024. Mistakes and modifications possible.